

CLAMP BACKS, MALLEABLE IRON

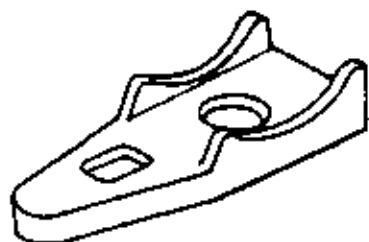

A = Overall length
 B = Width
 C = Hole diameter
 D = Slot size
 E = Height

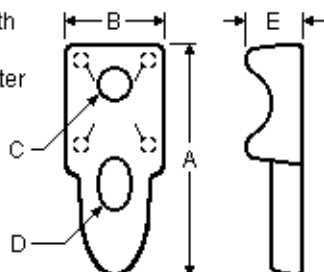

Dimensions
 = mm

For use with ONE-HOLE STRAPS to permit space between the conduit and the mounting surface. Use of clamp backs in outdoor locations can prevent the buildup of snow and rain between the conduit and the mounting surface. All malleable construction insures durability and mechanical protection. Zinc electro plated for added corrosion protection. Elongated bolt holes make alignment with straps easy.

Cat.No.	GRC-IMC	EMT	A	B	C	D	E	UPE/Pack	EDP No
1342	1/2"	3/4"	58.7	25.4	10.3	14.3x 9.5	11.1	100	113064
1343	3/4"	1"	60.3	26.2	10.3	14.3x11.1	11.1	100	113065
1344	1"	1 1/4"	76.2	31.8	9.5	15.1x11.9	14.3	50	113066
1345	1 1/4"	1 1/2"	92.1	37.3	11.9	19.1x12.7	17.5	25	113041
1346	1 1/2"	2"	99.2	39.7	11.1	19.8x11.1	12.7	25	113067
1348	2"	2"	120.7	49.2	14.3	23.0x15.9	24.6	10	113068
1347	2 1/2"	2 1/2"	149.2	60.3	12.7	25.4x19.1	22.2	10	113069
1349	3"	3"	171.5	65.1	12.7	25.4x19.1	22.2	10	113070
1350	3 1/2"	3 1/2"	185.7	71.4	12.7	25.4x19.1	25.4	5	113071
1351	4"	4"	210.3	74.6	12.7	25.4x19.1	25.4	5	113072