

Explosionproof and Dust-tight Fittings and Accessories

EXPLOSIONPROOF AND DUST-TIGHT JUNCTION BOXES CLASS I, GROUPS C & D; CLASS II, GROUPS E, F & G; NEMA 7 & NEMA 9 MULTI-HUB BOXES



Designed for general wiring in hazardous locations. For pulling and splicing conductors. Serves as mounting outlets with use of appropriate fixture covers.

Available with dome cover for additional splicing room and mounting of various devices.

Bodies XJAB, XJAD and XJAX 26 thru 46 have two interior mounting bosses, which can be blind tapped.
Bodies XJAC, XJAL and XJAT 26 thru 46 have four interior mounting bosses, which can be blind tapped.
All bodies 570 thru 890 have solid back, can be tapped blind.



Catalog Number	Conduit Size (In.)	Standard Pkg. Quantity	Standard Pkg. Weight Lbs.
XJAB-26	1/2	10	9
XJAB-36	3/4	10	10
XJAB-46	1	10	12
XJAB-570	1 1/4	5	25
XJAB-690	1 1/2	4	22
XJAB-890	2	4	23
XJAC-26	1/2	10	9
XJAC-36	3/4	10	10
XJAC-46	1	10	12
XJAC-570	1 1/4	5	26
XJAC-690	1 1/2	4	21
XJAC-890	2	4	23
XJAD-36	3/4	10	9
XJAD-46	1	10	15
XJAL-26	1/2	10	9
XJAL-36	3/4	10	10
XJAL-46	1	10	12
XJAL-570	1 1/4	5	26
XJAL-690	1 1/2	4	21
XJAL-890	2	4	23

NEMA 4 WATERTIGHT OPTIONAL:
Consult factory for availability and/or certifications.



Compliances

- NEC Class I, Groups C, D
Class II, Groups E, F, G
- UL Standard 886 - CSA Standard C22.2 No. 30

Explosionproof and Dust-tight Fittings and Accessories

EXPLOSIONPROOF AND DUST-TIGHT JUNCTION BOXES CLASS I, GROUPS C & D; CLASS II, GROUPS E, F & G; NEMA 7 & NEMA 9 MULTI-HUB BOXES



XJAL
(No bottom hub)



XJAT
(No bottom hub)



XJAX
(No bottom hub)

Catalog Number	Conduit Size (In.)	Standard Pkg. Quantity	Standard Pkg. Weight Lbs.
XJAT-26	1/2	10	10
XJAT-36	3/4	10	10
XJAT-46	1	10	13
XJAT-570	1 1/4	5	27
XJAT-690	1 1/2	4	21
XJAT-890	2	4	23
XJAX-26	1/2	10	12
XJAX-36	3/4	10	14
XJAX-46	1	10	15
XJAX-570	1 1/4	5	27
XJAX-690	1 1/2	4	21
XJAX890	2	4	23

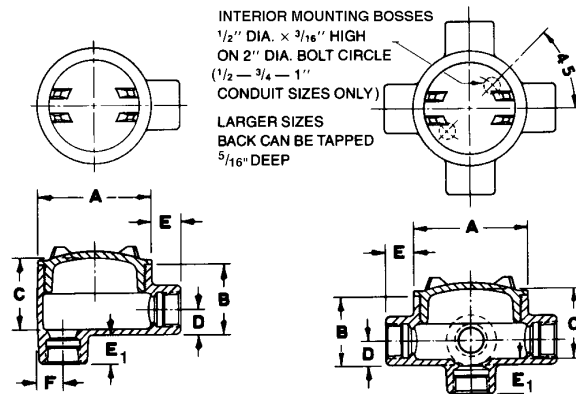

Bottom hub on XJAB and XJAD styles only.

DIMENSIONS (inches)							
Conduit Size	A	B	C	D	E	F	E ₁
1/2	3 1/2	2	2	5/8	7/8	1 1/16	7/8
3/4	3 1/2	2	2	3/4	7/8	1 3/16	7/8
1	3 1/2	2 5/16	2 5/16	7/8	1	1 5/16	1
1 1/4	6 3/8	3 9/16	3 3/4	1 3/32	1 1/16	1 13/32	1
1 1/2	6 3/8	3 7/16	3 3/4	1 9/32	3/4	1 19/32	1
2	6 3/8	3 1 3/16	4	1 1/16	3/4	1 7/8	1

NEMA 4 WATERTIGHT OPTIONAL:
Consult factory for availability and/or certifications.



Compliances

- NEC Class I, Groups C, D
Class II, Groups E, F, G
- UL Standard 886 - CSA Standard C22.2 No. 30

Explosionproof and Dust-tight Fittings and Accessories

EXPLOSIONPROOF AND DUST-TIGHT JUNCTION BOXES CLASS I, GROUPS C & D; CLASS II, GROUPS E, F & G; NEMA 7 & NEMA 9 MULTI-HUB BOXES

BLANK COVERS

Catalog Number	Description	St. Pkg.	Std. Pkg. Weight Lbs.
XJA6	For 1/2" - 3/4" - 1" Bodies	10	5
XJA8	For 1 1/4" - 1 1/2" - 2" Bodies	5	11



XJA6



XJA6S



XJADC

SEALING COVERS

Catalog Number	Description	St. Pkg.	Std. Pkg. Weight Lbs.
XJA6S	For 1/2" - 3/4" - 1" Bodies	10	7

Entire body must be filled with sealing compound. NEC prohibits splices and taps in sealing fittings.

DOME COVERS

Catalog Number	Description	St. Pkg.	Std. Pkg. Weight Lbs.
XJADC	For 1/2" - 3/4" - 1" Bodies Inside Depth 2 3/8"	10	9
XJAD4	For 1 1/4" - 1 1/2" - 2" Bodies Inside Depth 4 1/8"	1	5
XJAD6	For 1 1/4" - 1 1/2" - 2" Bodies Inside Depth 6"	1	6
XJAD10	For 1 1/4" - 1 1/2" - 2" Bodies Inside Depth 10"	1	8 1/2
XJAD13	For 1 1/4" - 1 1/2" - 2" Bodies Inside Depth 13"	1	9 1/2
XJAO	O-Ring For NEMA 4 watertight For 1/2" - 3/8" - 1" Bodies	1	—
XJTO	O-Ring for NEMA 4 watertight For 1 1/4" - 1 1/2" - 2" Bodies	1	—

To learn more about B-I-A please visit us at our
WEB site: www.BiaGmbH.com



Explosionproof and Dust-tight Fittings and Accessories

EXPLOSIONPROOF AND DUST-TIGHT SEALING FITTINGS CLASS I, GROUPS B*, C & D; CLASS II, GROUPS E, F & G; NEMA 7 & NEMA 9



XYB-XYBM

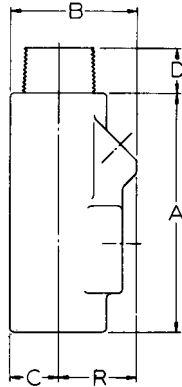

Sealing Fittings are required in Hazardous Locations and are used to isolate arc-producing devices in conduit and wiring systems, and to prevent the passage of explosive pressures from one area to another.

FOR HORIZONTAL AND VERTICAL MOUNTING - Type XYB and XYBM are suitable for either horizontal or vertical mounting and are provided with threaded plugged openings into which fiber and cement can be placed to form effective seal. XYB has female ends for conduit entrance. The XYBM has female ends with a removable threaded nipple.

*1/2", 3/4", 1" sizes Class I, Group B, C, D, Class II, E, F, G.

1 1/4", 1 1/2", 2", 2 1/2", 3", 3 1/2", 4" sizes Class I, Group C, D, Class II, E, F, G

CSA Certified LR27991

UL Listed E10493

Catalog No. Description	Conduit Size (In.)	Ounces Req. For Each Sealing Fitting		Standard Package	
		Cement	Fiber	Qty.	Tot. Wt. Lbs.
Female-Female					
XYB-2	1/2	1	1/8	5	2.1
XYB-3	3/4	2	1/4	5	2.6
XYB-4	1	3	1/4	5	3.7
XYB-5	1-1/4	6	3/8	2	2.5
XYB-6	1-1/2	9	1/2	2	3.2
XYB-8	2	18	3/4	2	5.6
XYB-10	2-1/2	23	1-1/2	2	6.2
XYB-12	3	48	3-1/8	1	6.0
XYB-14	3-1/2	70	4-1/2	1	6.8
XYB-16	4	90	6	1	8.3

Catalog No. Description	Conduit Size (In.)	Ounces Req. For Each Sealing Fitting		Standard Package	
		Cement	Fiber	Qty.	Tot. Wt. Lbs.
Male-Female					
XYBM-2	1/2	1	1/8	5	2.2
XYBM-3	3/4	2	1/4	5	2.7
XYBM-4	1	3	1/4	5	3.8
XYBM-5	1-1/4	6	3/8	2	2.6
XYBM-6	1-1/2	9	1/2	2	3.4
XYBM-8	2	18	3/4	2	5.9
XYBM-10	2-1/2	23	1-1/2	2	6.8
XYBM-12	3	48	3-1/8	1	6.3
XYBM-14	3-1/2	70	4-1/2	1	7.3
XYBM-16	4	90	6	1	8.8

Nominal Dimensions (Inches)					
Conduit Size	A	B	C	(XYBM Series Only)	Turn Radius R
				D	
1/2	3-19/32	1-13/16	5/8	11/16	1-3/16
3/4	3-25/32	2-1/16	3/4	15/16	1-5/16
1	4-3/8	2-5/16	7/8	15/16	1-7/16
1-1/4	5-5/32	2-13/16	1-1/16	1-1/16	1-3/4
1-1/2	5-11/16	3-3/16	1-3/16	1-3/16	2
2	6-13/16	3-7/8	1-1/2	1-7/16	2-3/8
2-1/2	7-1/2	4-1/2	1-7/8	1-5/8	2-11/16
3	9-9/16	5-1/2	2-3/16	1-7/8	3-5/16
3-1/2	9-1/2	6-1/6	2-3/8	2	3-11/16
4	9-9/16	6-1/2	2-5/8	2-1/8	3-7/8

Compliances

- NEC Class I, Groups B, C, D
Class II, Groups E, F, G
- UL Standard 886 - CSA Standard C22.2 No. 30

Explosionproof and Dust-tight Fittings and Accessories

EXPLOSIONPROOF AND DUST-TIGHT 40% FILL SEALING FITTINGS CLASS I, GROUPS B*, C & D; CLASS II, GROUPS E, F & G; NEMA 7 & NEMA 9



XYB-XYBM

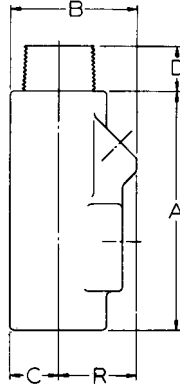

Sealing Fittings are used for the same application as the standard sealing fitting but allow up to 40% wire fill in the fitting.

*1/2", 3/4" sizes Class I, Group B, C, D, Class II, E, F, G.
1", 1-1/4", 1-1/2", 2", 2-1/2", 3" sizes Class I, Group C, D,
Class II, E, F, G.

CSA Certified LR27991

UL Listed E10493

Catalog No. Description	Conduit Size (In.)	Ounces Req. For Each Sealing Fitting		Standard Package	
		Cement	Fiber	Qty.	Tot. Wt. Lbs.
Female-Female					
XYB-34	1/2	2	1/4	5	2.6
XYB-44	3/4	3	1/4	5	3.7
XYB-54	1	6	3/8	2	2.5
XYB-84	1-1/4	18	3/4	2	5.6
XYB-104	1-1/2	23	1-1/2	2	6.2
XYB-124	2	48	3-1/8	1	6.0
XYB-144	2-1/2	70	4-1/2	1	6.8
XYB-164	3	90	6	1	8.3

Catalog No. Description	Conduit Size (In.)	Ounces Req. For Each Sealing Fitting		Standard Package	
		Cement	Fiber	Qty.	Tot. Wt. Lbs.
Male-Female					
XYBM-34	1/2	2	1/4	5	2.7
XYBM-44	3/4	3	1/4	5	3.8
XYBM-54	1	6	3/8	2	2.6
XYBM-84	1-1/4	18	3/4	2	5.9
XYBM-104	1-1/2	23	1-1/2	2	6.8
XYBM-124	2	48	3-1/8	1	6.3
XYBM-144	2-1/2	70	4-1/2	1	7.3
XYBM-164	3	90	6	1	8.8

Nominal Dimensions (Inches)					
Conduit Size	A	B	C	(XYBM Series Only)	Turn Radius R
				D	
1/2	3-25/32	2-1/16	3/4	15/16	1-5/16
3/4	4-3/8	2-5/16	7/8	15/16	1-7/16
1	5-5/32	2-13/16	1-1/16	1-1/16	1-3/4
1-1/4	6-13/16	3-7/8	1-1/2	1-7/16	2-3/8
1-1/2	7-1/2	4-1/2	1-7/8	1-5/8	2-11/16
2	9-9/16	5-1/2	2-3/16	1-7/8	3-5/16
2-1/2	9-1/2	6-1/16	2-3/8	2	3-11/16
3	9-9/16	6-1/2	2-5/8	2-1/8	3-7/8

Compliances

- NEC Class I, Groups B, C, D
Class II, Groups E, F, G
- UL Standard 886 - CSA Standard C22.2 No. 30

Explosionproof and Dust-tight Fittings and Accessories

EXPLOSIONPROOF AND DUST-TIGHT SEALING FITTINGS CLASS I, GROUP D; CLASS II, GROUPS E, F & G; NEMA 7 & NEMA 9

Sealing Fittings are used to isolate arc-producing devices from wiring systems and to prevent the spread of explosive gases.



XY 2-3-4



XYM 2-3-4



XY 5-6



XYM 5-6



XYC



XYCM



XYCS



XYCSM

FOR VERTICAL MOUNTING

Types XY and XYM Fittings are for vertical mounting, and are provided with threaded plugged openings into which the sealing cement is poured. Sizes 1-1/4" x 1-1/2" have large plugged openings in the lower hub to facilitate packing fiber around the wires to form a dam. Type XYM's have removable threaded nipples. The two hubs are tapped simultaneously to assure alignment of the conduits, especially important to equipment manufacturers using short runs of conduit.

FOR HORIZONTAL & VERTICAL MOUNTING

Type XYC Fittings are for horizontal mounting only, with the cover opening in an upright position. XYCS fittings are for vertical or horizontal mounting, with removable threaded covers which can be turned to the desired position for pouring in the sealing cement. The covers are interchangeable. The male-to-female types have removable threaded nipple.

Catalog Number		Conduit Size (In.)	Ounces Required per Fitting		Standard Package	
Female/Female	Male/Female		Sealing Cement	Packing Fiber	Qty	Weight Lbs.
XY2	XYM2	1/2	1	1/8	25	10
XY3	XYM3	3/4	1	1/4	25	10
XY4	XYM4	1	2	1/4	25	12-1/2
XY5	XYM5	1-1/4	4	3/8	10	7-1/2
XY6	XYM6	1-1/2	5	1/2	10	10
XYC2	XYC2M	1/2	2	1/8	25	13
XYC3	XYC3M	3/4	2	1/4	25	13
XYC4	XYCM4	1	4-1/2	1/4	25	15
XYC5	XYC5M	1-1/4	8-1/2	3/8	10	10
XYC6	XYC6M	1-1/2	11-1/2	1/2	10	11
XYC8	XYC8M	2	13-1/2	3/4	10	12
XYC10	XYC10M	2-1/2	15	1-1/2	1	2
XYC12	XYC12M	3	31-1/2	3-1/8	1	3
XYC14	XYC14M	3-1/2	42-1/2	4-1/2	1	4
XYC16	XYC16M	4	51	6	1	5
XYC2S	XYC2SM	1/2	2	1/8	25	13
XYC3S	XYC3SM	3/4	2	1/4	25	13
XYC4S	XYC4SM	1	3	1/4	25	15
XYC5S	XYC5SM	1-1/4	6-1/2	3/8	10	10
XYC6S	XYC6SM	1-1/2	10	1/2	10	11
XYC8S	XYC8SM	2	12-1/2	3/4	10	12
XYC10S	XYC10SM	2-1/2	13-1/2	1-1/2	1	2
XYC12S	XYC12SM	3	29-1/2	3-1/8	1	3
XYC14S	XYC14SM	3-1/2	40	4-1/2	1	4
XYC16S	XYC16SM	4	48-1/2	6	1	5

CSA Certified LR27991

UL Listed E10493

Compliances

- NEC Class I, Group D Class II, Groups E, F, G
- UL Standard 886 - CSA Standard C22.2 No. 30

Explosionproof and Dust-tight Fittings and Accessories

EXPLOSIONPROOF AND DUST-TIGHT 40% FILL SEALING FITTINGS CLASS I, GROUP D; CLASS II, GROUPS E, F & G; NEMA 7 & NEMA 9



XY 34, 44



XYM 34, 44



XY 54



XYM 54



XYC 34-XYC 164



XYC 34M-XYC 164M



XYC 34S-XYC 164S



XYC 34SM-XYC 164SM

40% Fill Sealing Fittings are used for the same applications as the standard Sealing Fittings, but allow up to 40% wire fill in the fitting.

Catalog Number		Conduit Size (In.)	Ounces Required per Fitting		Standard Package	
Female/Female	Male/Female		Sealing Cement	Packing Fiber	Qty	Weight Lbs.
XY34	XYM34	1/2	1	1/4	25	10
XY44	XYM44	3/4	2	1/4	25	12-1/2
XY54	XYM54	1	4	3/8	10	7-1/2
XYC34	XYC34M	1/2	2	1/4	25	13
XYC44	XYC44M	3/4	4-1/2	1/4	25	15
XYC54	XYC54M	1	8-1/2	3/8	10	10
XYC84	XYC84M	1-1/4	13-1/2	3/4	10	12
XYC104	XYC104M	1-1/2	15	1-1/2	1	2
XYC124	XYC124M	2	31-1/2	3-1/8	1	3
XYC144	XYC144M	2-1/2	42-1/2	4-1/2	1	4
XYC164	XYC164M	3	51	6	1	5
XYC34S	XYC34SM	1/2	2	1/4	25	13
XYC44S	XYC44SM	3/4	3	1/4	25	15
XYC54S	XYC54SM	1	6-1/2	3/8	10	10
XYC84S	XYC84SM	1-1/4	12-1/2	3/4	10	12
XYC104S	XYC104SM	1-1/2	13-1/2	1-1/2	1	2
XYC124S	XYC124SM	2	29-1/2	3-1/8	1	3
XYC144S	XYC144SM	2-1/2	40	4-1/2	1	4
XYC164S	XYC164SM	3	48-1/2	6	1	5

Compliances

- NEC Class I, Group D
Class II, Groups E, F, G
- UL Standard 886 - CSA Standard C22.2 No. 30

CSA Certified LR27991
UL Listed E10493

Explosionproof and Dust-tight Fittings and Accessories

EXPLOSIONPROOF AND DUST-TIGHT SEALING FITTINGS CLASS I, GROUP D; CLASS II, GROUPS E, F & G; NEMA 7 & NEMA 9

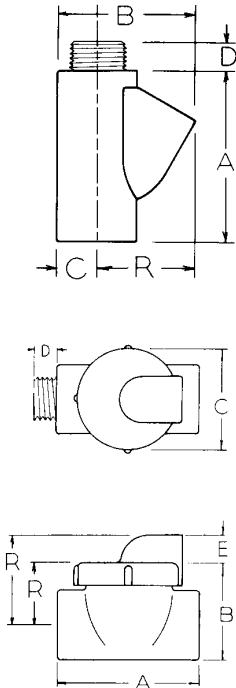

Catalog Number			Dimensions (In.)					R = Turning Radius (Inches)		
Female/ Female	Male/ Female	Conduit Size	Nominal Dimensions, (In.)					Plain Cover	Sealing Cover	No Cover
			A	B	C	D	E			
XY2	XYM2	1/2	3-1/16	2-7/16	3/4	11/16				1-13/16
XY3	XYM3	3/4	3-1/16	2-7/16	3/4	1				1-13/16
XY4	XYM4	1	3-3/4	2-15/16	15/16	15/16				2-1/8
XY5	XYM5	1-1/4	4-15/16	3-3/16	1-3/16	1-1/8				2-1/8
XY6	XYM6	1-1/2	4-7/8	3-7/16	1-5/16	1-5/16				2-1/4
XYC2	XYC2M	1/2	3-1/16	2-9/16	2-1/6	5/8	13/16	1-7/8	2-11/16	
XYC2S	XYC2SM									
XYC3	XYC3M	3/4	3-1/6	2-9/16	2-1/16	15/16	13/16	1-7/8	2-11/16	
XYC3S	XYC3SM									
XYC4	XYC4M	1	3-11/16	2-11/16	2-3/8	15/16	1	2-1/8	3-1/16	
XYC4	XYC4SM									
XYC5	XYC5M	1-1/4	4-1/2	3-3/16	3-3/8	1-1/16	7/8	2-11/16	3-1/16	
XYC5S	XYC5SM									
XYC6	XYC6M	1-1/2	4-1/2	3-7/16	3-3/8	1-1/8	7/8	2-11/16	3-1/16	
XYC6S	XYC6SM									
XYC8	XYC8M	2	4-11/16	4	3-3/8	1-3/8	7/8	3	3-5/16	
XYC8S	XYC8SM									
XYC10	XYC10M	2-1/2	5-5/16	4-5/8	3-3/8	1-5/8	7/8	3-1/4	3-3/4	
XYC10S	XYC10SM									
XYC12	XYC12M	3	6-7/16	5-7/16	3-15/16	1-3/4	1-3/8	4	4-5/8	
XYC12S	XYC12SM									
XYC14	XYC14M	3-1/2	6-9/16	6-3/8	4-3/4	1-5/8	1-5/16	4-5/8	5	
XYC14S	XYC14SM									
XYC16	XYC16M	4	6-15/16	6-13/16	4-3/4	2	1-5/16	4-3/4	5-3/8	

CSA Certified LR27991

UL Listed E10493

ADACO SEALING CEMENT AND ADACO PACKING FIBER CLASS I, GROUPS B, C & D; CLASS II, GROUPS E, F & G; NEMA 7 & NEMA 9



XSC

XAF

Catalog No.	Description	Net Weight
XSC-8	ADACO No. 1	8 oz.
XSC-16	Sealing	16 oz.
XSC-160	Cement	10 lbs.
XAF-6	ADACO	1-1/2 oz.
XAF-24	Packing	6 oz.
XAF-64	Fiber	1 lb.

ADACO SEALING CEMENT is the easiest-to-use sealing cement on the market. The powder is contained in a polyethylene bag within an outer container. To mix, remove the bag of powder, fill the outside container with water up to the marked "water line" and pour in the powder. Simple...no guesswork about how much water to use. The mixing container is right there...and clean. The largest unit package offered contains one pound of powder. The XSC-160 (10-pound quantity) consists of 10, one-pound packages (at the ten-pound price) so that every mix is correct. This cement has been especially prepared for use in Sealing Fittings. It is not an insulating compound, and is not affected by gasoline, alcohol, benzol, oils, acetone or lacquer solvents.

ADACO PACKING FIBER is used with Adaco Sealing Cement for plugging conduit openings in fittings. Alumina Silica based long fiber non-asbestos for use as a packing at the hubs of sealing units to prevent the Sealing Cement in the liquid state from entering the conduit lines. The Fiber is tamped between the wires and the hub before the Sealing Cement is poured into the fitting.

Explosionproof and Dust-tight Fittings and Accessories

EXPLOSIONPROOF AND DUST-TIGHT 40% FILL SEALING FITTINGS CLASS I, GROUP D; CLASS II, GROUPS E, F & G; NEMA 7 & NEMA 9

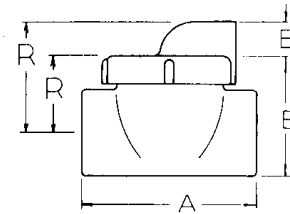
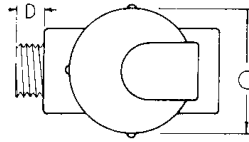
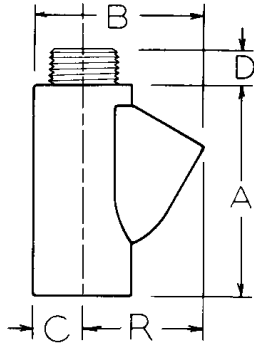

Catalog Number		Conduit Size	Dimensions (In.)					R = Turning Radius (Inches)		
Female/Female	Male/Female		Nominal Dimensions, (In.)					Plain Cover	Sealing Cover	No Cover
			A	B	C	D	E			
XY34	XYM34	1/2	3-1/6	2-7/16	3/4	1				1-13/16
XY44	XYM44	3/4	3-3/4	2-15/16	15/16	15/16				3-1/8
XY54	XYM54	1	4-15/16	3-3/16	1-3/16	1-1/8				2-1/8
XYC34	XYC34M	1/2	3-1/6	2-9/16	2-1/16	15/16	13/16	1-7/8	2-11/16	
XYC34S	XYC34SM									
XYC44	XYC44M	3/4	3-11/16	2-11/16	2-3/8	15/16	1	2-1/8	3-1/16	
XYC44S	XYC44SM									
XYC54	XYC54M	1	4-1/2	3-3/16	3-3/8	1-1/16	7/8	2-11/16	3-1/16	
XYC54S	XYC54SM									
XYC84	XYC84M	1-1/4	4-11/16	4	3-3/8	1-3/8	7/8	3	3-5/16	
XYC84S	XYC84SM									
XYC104	XYC104M	1-1/2	5-5/16	4-5/8	3-3/8	1-5/8	7/8	3-1/4	3-3/4	
XYC104S	XYC104SM									
XYC124	XYC124M	2	6-7/16	5-7/16	3-15/16	1-3/4	1-3/8	4	4-5/8	
XYC124S	XYC124SM									
XYC144	XYC144M	2-1/2	6-9/16	6-3/8	4-3/4	1-5/8	1-5/16	4-5/8	5	
XYC144S	XYC144SM									
XYC164	XYC164M	3	6-15/16	6-13/16	4-3/4	2	1-5/16	4-3/4	5-3/8	
XYC164S	XYC164SM									

To learn more about B-I-A please visit us at our
WEB site: www.BiaGmbH.com



Explosionproof and Dust-tight Fittings and Accessories

**EXPLOSIONPROOF AND DUST-TIGHT
SHORT RADIUS PULL ELBOWS**

CLASS I, GROUP D; CLASS II, GROUPS E, F & G; NEMA 7 & 9



FL

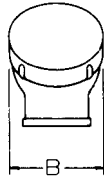

MFL

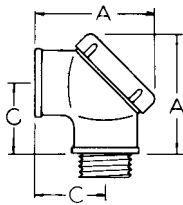

This versatile and inexpensive explosion-proof fitting with a threaded cover will easily and compactly handle 90° conduit runs. FL series have two female entrances. MFL series has one female entrance and one removable threaded nipple.

Catalog Number	Conduit Size (In.)	Nominal Dimensions Inches			Standard Package	
		A	B	C	Quantity	Weight Pounds
FL92	1/2	2-5/8	2-1/8	1-3/8	25	8
FL93	3/4	2-13/16	2-1/8	1-1/2	25	10-1/2
FL94	1	3-1/4	2-7/16	1-7/8	25	11
FL95	1-1/4	3-3/4	3-1/2	2-1/4	25	24
*FL96	1-1/2	4-5/8	4-3/16	2-5/8	25	30
MFL92	1/2	2-5/8	2-1/8	1-3/8	25	9
MFL93	3/4	2-13/16	2-1/8	1-1/2	25	12
MFL94	1	3-1/4	2-7/16	1-7/8	25	13
MFL95	1-1/4	3-3/4	3-1/2	2-1/4	25	26
*MFL96	1-1/2	4-5/8	4-3/16	2-5/8	25	34

Compliances

- NEC Class I, Group D
Class II, Groups E, F, G

- UL Standard 886 - CSA Standard C22.2 No. 30

* Fitting not UL Listed or CSA Certified

CSA Certified LR27991

UL Listed E10493

**EXPLOSIONPROOF AND DUST-TIGHT REMOVABLE PLUGS
CLASS I, GROUPS A, B, C & D; CLASS II, GROUPS E, F & G;
NEMA 7 & NEMA 9**

Tapered thread close-up plugs for explosionproof conduit entrances. Provides 5 full threads of engagement. Made of aluminum alloy, these plugs have screw-driver slots and fit practically flush when installed.



OX

Catalog Number	Conduit Size (In.)	Standard Package		Catalog Number	Conduit Size (In.)	Standard Package	
		Qty	Weight Pounds			Qty	Weight Pounds
OX2	1/2	250	6-3/4	OX8	2	50	12
OX3	3/4	250	10-1/4	OX10	2-1/2	50	20-1/2
OX4	1	150	9	OX12	3	50	30
OX5	1-1/4	100	12	OX14	3-1/2	50	40
OX6	1-1/2	100	14-1/2	OX16	4	50	52

Explosionproof and Dust-tight Fittings and Accessories

EXPLOSIONPROOF AND DUST-TIGHT CONDUIT UNIONS CLASS I, GROUPS A, B, C & D; CLASS II, GROUPS E, F & G; NEMA 7 & NEMA 9

Explosionproof unions for use in conduit piping systems for ease of installation and removal of fittings, boxes and equipment enclosures in hazardous atmosphere areas. Parts are steel, cadmium plated for corrosion protection. Style XU has two female NPT threads. Style XUM has two female NPT threads and one plated threaded nipple.



XU

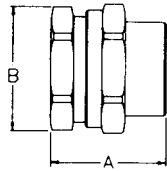

XUM

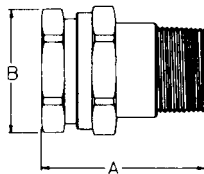

Catalog Number	Conduit Size		Standard Package	
			Qty	Weight Pounds
XU2	1/2"	Female-Female	50	19
XU3	3/4"	Female-Female	50	21
XU4	1"	Female-Female	25	13-1/2
XUM2	1/2"	Female-Male	50	22
XUM3	3/4"	Female-Male	50	26
XUM4	1"	Female-Male	25	16-1/2

DIMENSIONS

	Conduit Size	A	B
Series	1/2"	1-3/4"	1-1/2"
XU	3/4"	1-3/4"	1-3/4"
	1"	1-15/16"	2"
Series	1/2"	2-9/16"	1-1/2"
XUM	3/4"	2-3/4"	1-3/4"
	1"	3"	2"

CSA Certified LR27991

UL Listed E10493

Compliance

- NEC Class I, Groups A, B, C, D
Class II, Groups E, F, G
- UL Standard 886 - CSA Standard C22.2 No.30

Explosionproof and Dust-tight Fittings and Accessories

EXPLOSIONPROOF AND DUST-TIGHT FLEXIBLE COUPLINGS

*CLASS I, GROUPS A, B, C & D; CLASS II, GROUPS E, F & G; NEMA 7 & NEMA 9

Application: XFC couplings are for use in Hazardous Atmospheres where a flexible connection is required for motor and equipment installation where movement and vibration are present. Also for difficult bends and connections.

Material: Brass and bronze end fittings. Bronze wire flexible braid covering over flexible bronze core with insulating liner. INCLUDES TWO REMOVABLE ZINC CLEAR COATED NIPPLES.

NOTE: For stainless steel in 1/2" and 3/4" sizes add SS suffix (XFCSS-) nipples not included.

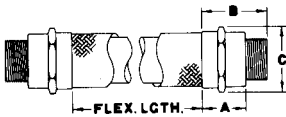

Nominal Dimensions (inches)							
Catalog Number	Conduit Size	Flex Length	Weight Pounds	Catalog Number	Conduit Size	Flex Length	Weight Pounds
XFC-24	1/2	4	1-3/4	XFC-410	1	10	2-5/8
XFC-26	1/2	6	2	XFC-412	1	12	2-3/4
XFC-28	1/2	8	2-1/2	XFC-415	1	15	3
XFC-210	1/2	10	2-3/8	XFC-418	1	18	3-1/4
XFC-212	1/2	12	2-1/2	XFC-421	1	21	3-1/2
XFC-215	1/2	15	2-5/8	XFC-424	1	24	3-3/4
XFC-218	1/2	18	3	XFC-427	1	27	4-1/8
XFC-221	1/2	21	3-1/8	XFC-430	1	30	4-1/2
XFC-224	1/2	24	3-1/4	XFC-433	1	33	4-7/8
XFC-227	1/2	27	3-3/8	XFC-436	1	36	5-1/4
XFC-230	1/2	30	3-1/2	XFC-512	1-1/4	12	6-1/2
XFC-233	1/2	33	3-3/4	XFC-515	1/14	15	7
XFC-236	1/2	36	4	XFC-518	1-1/4	18	7-1/2
XFC-34	3/4	4	2	XFC-521	1-1/4	21	8-1/4
XFC-36	3/4	6	2-1/4	XFC-524	1-1/4	24	8-3/4
XFC-38	3/4	8	2-3/8	XFC-527	1-1/4	27	9-1/2
XFC-310	3/4	10	2-1/2	XFC-530	1-1/4	30	10-1/4
XFC-312	3/4	12	2-5/8	XFC-533	1-1/4	33	10-3/4
XFC-315	3/4	15	3	XFC-536	1-1/4	36	11-1/4
XFC-318	3/4	18	3-1/8	XFC-612	1-1/2	12	8-1/4
XFC-321	3/4	21	3-1/4	XFC-615	1-1/2	15	9
XFC-324	3/4	24	3-3/8	XFC-618	1-1/2	18	10
XFC-327	3/4	27	3-1/2	XFC-621	1-1/2	21	11
XFC-330	3/4	30	3-3/4	XFC-624	1-1/2	24	12
XFC-333	3/4	33	4	XFC-627	1-1/2	27	13
XFC-336	3/4	36	4-1/2	XFC-630	1-1/2	30	14
XFC-46	1	6	2-1/4	XFC-633	1-1/2	33	15
XFC-48	1	8	2-1/2	XFC-636	1-1/2	36	16

Nominal Dimensions (inches)						
Catalog Number	Conduit Size	Classification*	A	B	C	Min. Radius Bend
Series XFC	1/2	Class I & II	1-11/16	2-5/16	1-7/16	12
	3/4	Group A, B, C, D, E, F & G	1-3/4	2-5/8	1-7/8	14
	1	Class I & II				
		Group C, D, E, F & G	2	3	2-5/16	14
	1-1/4	Class I & II	2-1/8	3-3/8	2-3/4	16
1-1/2	Group D, E, F & G	2-1/2	3-7/8	3-5/16	16	

CSA Certified LR27991

UL Listed E10493

Compliances

- NEC Class I, Groups A, B, C, D
Class II, Groups E, F, G

- UL Standard 886 - CSA Standard C22.2 No. 30

Explosionproof and Dust-tight Fittings and Accessories

EXPLOSIONPROOF AND DUST-TIGHT FLEXIBLE COUPLINGS

***CLASS I, GROUPS A, B, C & D;**

CLASS II, GROUPS E, F & G; NEMA 7 & NEMA 9

Application: XFCU couplings are for use in Hazardous Atmospheres where a flexible connection is required for motor and equipment installation where movement and vibration are present. Also for difficult bends and connections.

Material: Brass and bronze end fittings. Bronze wire flexible braid covering over flexible bronze core with insulating liner. INCLUDES ONE REMOVABLE ZINC CLEAR COATED NIPPLE ON ONE SIDE AND ONE UNION FITTING ON THE OTHER SIDE.

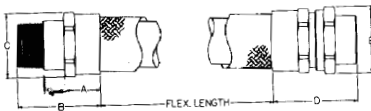

 CSA Certified LR27991

 UL Listed E10493

Nominal Dimensions (inches)							
Catalog Number	Conduit Size	Flex Length	Weight Pounds	Catalog Number	Conduit Size	Flex Length	Weight Pounds
XFCU-24	1/2	4	2	XFCU-410	1	10	3
XFCU-26	1/2	6	2-1/4	XFCU-412	1	12	3-1/8
XFCU-28	1/2	8	2-1/2	XFCU-415	1	15	3-3/8
XFCU-210	1/2	10	2-5/8	XFCU-418	1	18	3-5/8
XFCU-212	1/2	12	2-3/4	XFCU-421	1	21	3-7/8
XFCU-215	1/2	15	3-1/8	XFCU-424	1	24	4-1/8
XFCU-218	1/2	18	3-1/4	XFCU-427	1	27	4-1/2
XFCU-221	1/2	21	3-3/8	XFCU-430	1	30	4-5/8
XFCU-224	1/2	24	3-1/2	XFCU-433	1	33	5-1/8
XFCU-227	1/2	27	3-5/8	XFCU-436	1	36	5-1/2
XFCU-230	1/2	30	3-3/4				
XFCU-233	1/2	33	4				
XFCU-236	1/2	36	4-1/4				
XFCU-34	3/4	4	2-1/4				
XFCU-36	3/4	6	2-1/2				
XFCU-38	3/4	8	2-5/8				
XFCU-310	3/4	10	2-3/4				
XFCU-312	3/4	12	3-1/8				
XFCU-315	3/4	15	3-1/4				
XFCU-318	3/4	18	3-3/8				
XFCU-321	3/4	21	3-1/2				
XFCU-324	3/4	24	3-5/8				
XFCU-327	3/4	27	3-3/4				
XFCU-330	3/4	30	4				
XFCU-333	3/4	33	4-1/4				
XFCU-336	3/4	36	4-3/4				
XFCU-46	1	6	2-5/8				
XFCU-48	1	8	2-7/8				

Nominal Dimensions (inches)									
Catalog Number	Conduit Size	Classification*	A	B	C	D	E	Min. Radius Bend	
Series XFCU	1/2	Class I & II	1-11/16	2-5/16	1-7/16	2-7/16	1-1/2	12	
	3/4	Group A,B,C,D,E,F & G	1-3/4	2-5/8	1-7/8	2-1/2	1-3/4	14	
	1	Class I & II							
		Group C,D,E,F & G	2	3	2-5/16	2-13/16	2	14	

Compliances

- NEC Class I, Groups A, B, C, D
Class II, Groups E, F, G
- UL Standard 886 - CSA Standard C22.2 No. 30

Explosionproof and Dust-tight Fittings and Accessories

**EXPLOSIONPROOF AND DUST-TIGHT
COMBINATION BREATHER/DRAIN
CLASS I, GROUPS C & D;
CLASS II, GROUPS F & G; NEMA 7 & NEMA 9**

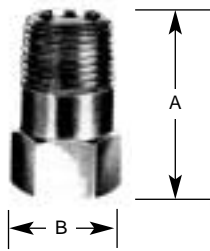

XDB2

Stainless steel combination breather drain. Install in top of enclosures as breather. Install in bottom of enclosure as drain.

Nominal Dimensions (inches)			
Catalog Number	Thread	A	B
XDB2	1/2 NPT	1-5/8	7/8 hex

Compliances

- NEC Class I, Groups C, D Class II, Groups E, F, G - Class III
- UL Standard 886 - CSA Standard C22.2 No. 30

- CSA Certified LR27991
- UL Listed E10493

**EXPLOSIONPROOF AND DUST-TIGHT
COMBINATION BREATHER/DRAIN
CLASS I, GROUPS A, B, C & D;
CLASS II, GROUPS E, F & G; NEMA 7 & NEMA 9**

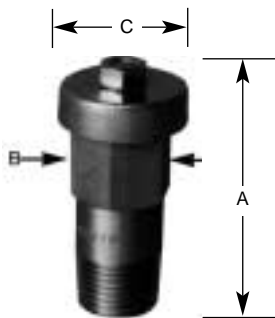

XDBH2

Nominal Dimensions (inches)				
Catalog Number	Thread	A	B	C
XDBH2	1/2 NPT	2-7/16	7/8 HEX	1-1/4

Flow Rate:

- .01 CFM air
- .5 cc/minute water

Certifications

- Class I, Groups A, B, C and D Class II, Groups E, F & G - Class III

UL and CSA

UL Standard 886 - CSA Standard C22.2 No. 30

- CENELEC EExd IIB DEMKO 00E.004127U

- CSA Certified LR27991
- UL Listed E10493

Explosionproof and Dust-tight Fittings and Accessories

EXPLOSIONPROOF FLAME ARRESTOR FITTING CLASS I, GROUPS B*, C & D NEMA 7



Typical XFA2



Typical XFAX2

APPLICATION: Provides thru-wall connections of tubing systems for electro/pneumatic and gas analysis devices installed within explosion proof enclosures.

The flame arrestor fitting is designed to prevent flame propagation thru tubing systems with minimum flow restrictions of control pressures.

MATERIAL: Stainless steel

Catalog Number	Description	Weight
XFA2	1/2" NPT	4 oz.
XFAX2	1/2" NPT	4 oz.

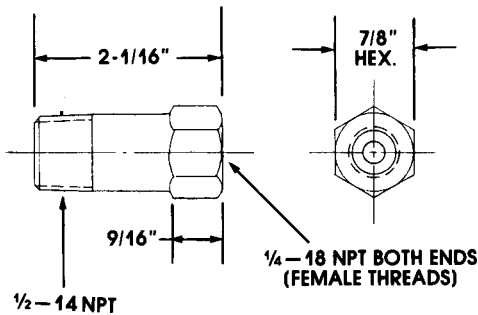

TYPICAL FIELD INSTALLATION

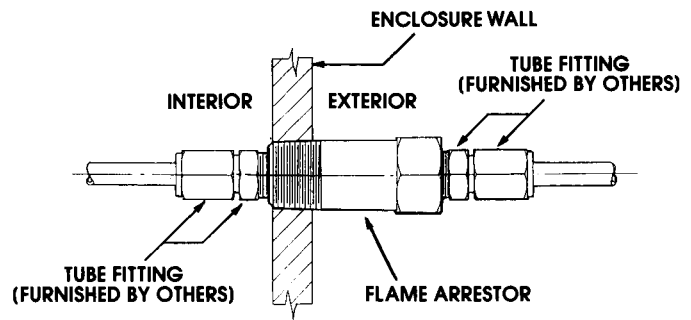

Exterior enclosure wall counter boring may be required to maintain 1/2" enclosure wall thickness for ease of field connections.

XFA2

Approximate Control Restrictions

- * 0.5 PSI drop at 20 CFH airflow
- * 1.3 PSI drop at 34 CFH airflow

- * NEC Class I, Groups C & D
- * UL Recognized Component
- * CSA Certified Component
- * CENELEC EExd Group IIB

*XFAX2

Approximate Control Restrictions

- 1 PSI drop at 18 CFH airflow
- 5 PSI drop at 53 CFH airflow

- UL and CSA Class I, Groups B, C & D
- CENELEC EExd Group IIB
- DEMKO 00E.0041270



CSA Certified LR27991



UL Recognized E10493

Fittings and Accessories

SALI INSULATING BUSHINGS (SUPERIOR LAMINATED INSULATION)

Sali bushings are machined from paper laminated phenolic material and comply with NEMA-X phenolic material specifications.



Specifications:

- 11,000 psi tensile
- 17,000 flexural
- 450v/mil dielectric
- Heat resistance - 150° C, continuous
- Moisture absorption - 1/2 of 1%
- Listed by Underwriters Laboratories for your quality assurance.
- Sali bushings have been repeatedly proved in a wide variety of applications over a 25 year period.

TYPE PE-FEMALE-DEEP-THREADED

 E10016

Catalog Number	Conduit Size (Inches)	Carton Qty.	Wt. Per Hundred (Lbs.)	Nominal Dimensions (Inches)		
				I.D.	O.D.	Height
PE-2	1/2	50	1-1/2	5/8	1-1/8	5/8
PE-3	3/4	50	2	13/16	1-5/16	5/8
PE-4	1	50	3-1/2	1	1-5/8	25/32
PE-5	1-1/4	25	4-1/2	1-3/8	2	25/32
PE-6	1-1/2	25	5-1/2	1-5/8	2-1/4	25/32
PE-8	2	10	7-1/2	2	2-3/4	25/32
PE-10	2-1/2	5	12	2-7/16	3-1/4	1
PE-12	3	5	16	3	3-7/8	1-1/16
PE-14	3-1/2	5	19	3-1/2	4-3/8	1-1/16
PE-16	4	2	24	4	5	1-1/16

Recommended for rigid conduit or in combination with male type PEM when maximum thread engagement is required.

TYPE PES-FEMALE-SHALLOW-THREADED

 E10016

Catalog Number	Conduit Size (Inches)	Carton Qty.	Wt. Per Hundred (Lbs.)	Nominal Dimensions (Inches)		
				I.D.	O.D.	Height
PES-2	1/2	50	1-1/2	5/8	1-1/8	1/2
PES-3	3/4	50	2	13/16	1-5/16	1/2
PES-4	1	50	3	1	1-5/8	5/8
PES-5	1-1/4	25	4	1-3/8	2	5/8
PES-6	1-1/2	25	4-1/2	1-5/8	2-1/4	5/8
PES-8	2	10	7	2	2-3/4	5/8
PES-10	2 1/2	5	11	2-7/16	3-1/4	13/16
PES-12	3	5	14	3	3-7/8	7/8
PES-14	3-1/2	5	16-1/2	3-1/2	4-3/8	7/8
PES-16	4	2	25	4	5	7/8

Designed for general use on rigid conduit, connectors, and similar installations where the additional mechanical strength of the deep type bushings is not needed.

Fittings and Accessories

TYPE PET-THREADLESS-FOR RIGID CONDUIT-FEMALE-SET SCREW THREADLESS



For threadless rigid conduit on all free conduit terminals such as terminating behind or within switchboards, switchgear, etc.

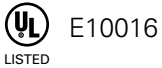

Catalog Number	Conduit Size (Inches)	Carton Qty.	Wt. Per Hundred (Lbs.)	Nominal Dimensions (Inches)			
				I.D. 1	O.D.	Height	I.D. 2
PET-2	1/2	50	1-1/2	5/8	1-1/8	5/8	7/8
PET-3	3/4	50	2	13/16	1-5/16	5/8	1-1/16
PET-4	1	50	3-1/2	1	1-5/8	25/32	1-11/32
PET-5	1-1/4	25	4-1/2	1-3/8	2	25/32	1-11/16
PET-6	1-1/2	25	5-1/2	1-5/8	2-1/4	25/32	1-15/16
PET-8	2	10	7-1/2	2	2-3/4	25/32	2-13/32
PET-10	2-1/2	5	12	2-7/16	3-1/4	1	2-29/32
PET-12	3	5	14	3	3-7/8	1-1/16	3-17/32
PET-14	3-1/2	5	17	3-1/2	4-3/8	1-1/16	4-1/32
PET-16	4	2	25	4	5	1-1/16	4-17/32

TYPE SPE-THREADLESS-FOR EMT-FEMALE-SET SCREW

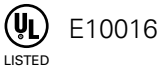

For use directly on thin wall conduit.

Catalog Number	Conduit Size (Inches)	Carton Qty.	Wt. Per Hundred (Lbs.)	Nominal Dimensions (Inches)			
				I.D. 1	O.D.	Height	I.D. 2
SPE-2	1/2	50	1-3/4	5/8	1-1/8	5/8	23/32
SPE-3	3/4	50	2-1/4	13/16	1-5/16	5/8	15/16
SPE-4	1	50	3-3/4	1	1-5/8	25/32	1-3/16
SPE-5	1-1/4	25	5-1/4	1-3/8	2	25/32	1-17/32
SPE-6	1-1/2	25	6	1-5/8	2-1/4	25/32	1-25/32
SPE-8	2	10	8-1/4	2	2-3/4	25/32	2-7/32

For EMT sizes 2-1/2 thru 4" use type PET.

TYPE PEM



A high strength resilient male bushing recommended to protect wires passing through steel cabinet walls, metal partitions and similar applications. For additional strength it is recommended this bushing be secured with type PE deep threaded female bushing.

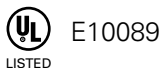

Catalog Number	Conduit Size (Inches)	Carton Qty.	Wt. Per Hundred (Lbs.)	Nominal Dimensions (Inches)		
				I.D.	O.D.	Height
PEM-2	1/2	50	1	5/8	1-1/8	5/8
PEM-3	3/4	50	1-1/2	13/16	1-5/16	5/8
PEM-4	1	50	2-1/2	1	1-5/8	25/32
PEM-5	1-1/4	25	3	1-3/8	2	25/32
PEM-6	1-1/2	25	4	1-5/8	2-1/4	25/32
PEM-8	2	10	6	2	2-3/4	25/32
PEM-10	2-1/2	5	10	2-7/16	3-1/4	1-1/16
PEM-12	3	5	14	3	3-7/8	1-1/16
PEM-14	3-1/2	5	16-1/2	3-1/2	4-3/8	1-1/16
PEM-16	4	2	21	4	5	1-1/16

Fittings and Accessories

TYPE PEML WITH LOCKNUT



A high strength resilient male bushing recommended to protect wires passing through metal walls, partitions and similar applications. Furnished with metallic locknuts.

Catalog Number	Conduit Size (Inches)	Carton Qty.	Wt. Per Hundred (Lbs.)	Nominal Dimensions (Inches)		
				I.D.	O.D.	Height
PEML-2	1/2	50	2-1/2	5/8	1-1/8	5/8
PEML-3	3/4	50	3-1/2	13/16	1-5/16	5/8
PEML-4	1	50	6	1	1-5/8	25/32
PEML-5	1-1/4	25	6-1/2	1-3/8	2	25/32
PEML-6	1-1/2	25	9	1-5/8	2-1/4	25/32
PEML-8	2	10	11	2	2-3/4	25/32
PEML-10	2-1/2	5	30	2-7/16	3-1/4	1-1/16
PEML-12	3	5	34	3	3-7/8	1-1/16
PEML-14	3-1/2	5	39	3-1/2	4-3/8	1-1/16
PEML-16	4	2	56	4	5	1-1/16

Poly PRECISION MOLDED INSULATING BUSHINGS



A rugged, high strength molded bushing for general use on rigid conduit connectors and similar installations.

Listed by Underwriters Laboratories Inc. for 105° C (221° F). Meets all requirements of National Electrical Code for insulating bushings.

Catalog Number	Conduit Size (Inches)	Carton Qty.	Wt. Per Hundred (Lbs.)	Nominal Dimensions (Inches)		
				I.D.	O.D.	Height
PM-2	1/2	100	1	19/32	1-1/16	13/32
PM-3	3/4	100	1	25/32	1-5/16	13/32
PM-4	1	50	2	1	1-5/8	1/2
PM-5	1-1/4	25	3	1-5/16	2	1/2
PM-6	1-1/2	25	3	1-17/32	2-7/32	9/16
PM-8	2	10	6	1-31/32	2-21/32	9/16
PM-10	2-1/2	5	11	2-5/16	3-5/16	5/8
PM-12	3	5	14	2-7/8	3-15/16	11/16
PM-14	3-1/2	5	22	3-5/16	4-7/16	11/16
PM-16	4	5	23	3-25/32	4-29/32	11/16
PM-20	5	2	40	4-13/16	6-3/16	31/32
PM-24	6	2	50	5-3/4	7-9/32	31/32

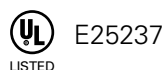

To learn more about B-I-A please visit us at our
WEB site: www.BiaGmbH.com



Fittings and Accessories

FIXTURE HANGERS SWIVEL SELF ALIGNING OUTLET BOX COVERS

Types SA-342 and SA-42

Self-aligning covers provide flexible suspension assuring plumb alignment of the lighting fixture regardless of ceiling structure or angle. Fixtures hung from these aligner covers can be hit or bumped without damage that would be caused if rigidly mounted.

Made of stamped steel, these Aligner Covers are equipped with ball joint allowing the fixture to swing through an angle of 20° in any direction of the perpendicular. The SA-342 has two sets of supporting screw hole centers for 3-1/4" and 4" octagonal outlet boxes and covers are spotted for 2-3/4" mounting centers. Type SA-42 has two sets of supporting screw holes for 4" square outlet boxes and covers are spotted for 3-1/2" and 2-3/4" centers for 4" and 3-1/2" octagonal boxes.

Catalog Number	Unit Carton Qty.	Standard Package	Approx Wt. Std. Pkg.
*SA-342	25	100	41
SA-42	25	100	50

Ball tapped for 1/2" stem.



SA-342



SA-42

*  UL Listed E88804

Sky-Tie™ — Bus-Drop Cable Clamps

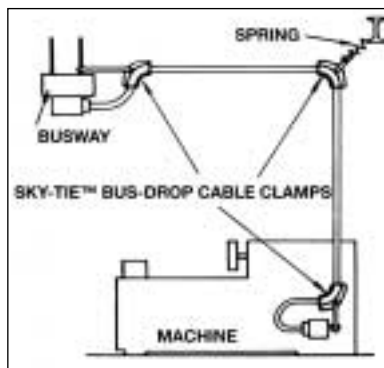

Supports...

Cable up to 1-1/8" diameter. Uniform "lap" design of each clamp-half results in support along the entire quarter bend.

Anchors...

Cable for 90° angle transitions using a simple, two-piece construction of interchangeable clamp-halves.

Loops...

Excess cable for convenient handling and out-of-the-way storage, via the Sky-Tie™ SHD Duplex Converter. The SHD reduces the need to cut cable when machines are moved to new locations. The SHD converter simply fits between the two halves of the Sky-Tie™ SH cable clamps.

Perfect For:

- Machine Tools
- Portable Tools
- Air Lines
- Other heavy-cable support applications.

Sky-Tie™ Springs

Heavy-duty Sky-Tie™ Springs insure tautness of the cable, while absorbing vibrations and shocks. Each spring slips into the Sky-Tie™ clamp at its outside bend (or, if using the SHD Duplex, the converter's outside bend), and ties back to a structural member. Three spring models with maximum load capacities of 60, 70 and 160 pounds.

Sky-Tie™ Springs

Catalog Number	Max. Spring Load	Carton Qty.	Approx. Wt.	Std. Pkg. Qty.	Approx. Wt.
SHS-50	60 lbs.	10	2.2	50	11
SHS-75	70 lbs.	10	2.7	50	14
SHS-1125	160 lbs.	10	11	10	11

Sky-Tie™ Two-In-One Cable Clamps

Catalog Number	Cable OD (Inches)	Typical Multi-Conductor Cable Size	Carton Qty.	Approx. Wt.	Std. Pkg. Qty.	Approx. Wt.
SH-50	1/2 to 3/4	14/4 thru 8/4	10	3.5	50	18.5
SH-75	3/4 to 1-1/8	8/4 thru 3/4 or (1) 500 MCM	10	7	50	36
SH-1125	1-1/8 to 1-11/16	Special Applications	5	10	25	50

Sky-Tie™ "Duplex" Component

Catalog Number	Cable OD (Inches)	Typical Multi-Conductor Cable Size	Carton Qty.	Approx. Wt.	Std. Pkg. Qty.	Approx. Wt.
SHD-50	1/2 to 3/4	14/4 thru 3/4	10	3.25	50	17.25
SHD-75	3/4 to 1-1/2	8/4 thru 3/4 or (1) 500 MCM	10	7	50	36

