

LIQUIDTIGHT CONDUIT AND CORD CONNECTORS STEEL/MALLEABLE IRON - STRAIGHT CONNECTORS



Applications

- For use in outdoor or indoor locations on flexible metallic liquidtight conduit and Type B flexible nonmetallic liquidtight conduit
- Use to positively bond the conduit to a box or enclosure
- These liquidtight connectors are suitable for use in Class 1, Division 2; Class 2, Division 1 and 2; and Class 3, Division 1 and 2 hazardous locations

Product Features

- Patented split gland-ring is designed to slip onto the conduit quickly and to grip the jacket of the conduit, speeding installation, assuring a perfect seal, and preventing pullouts
- Screw machined bodies (straight through 1") and precision threaded malleable iron castings mate with other components perfectly without strain or distortion
- All components are reusable — these liquidtight connectors may be easily disassembled and reused after years of service
- Sealing washer (included) provides a liquidtight seal when terminating the connector in a threadless opening
- Heavy duty locknut included with every liquidtight connector assures continuity of ground
- All metallic components are zinc electro plated for added corrosion protection
- UPC bar coded fittings are individually polybagged with a preprinted UPC-A bar code and packaged in pre-scored tear top cartons for an attractive presentation

Compliances

-  - Standard 514B
-  - C22.2 #18

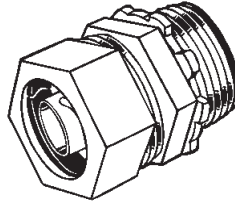

STRAIGHT-INSULATED
STEEL/MALLEABLE IRON

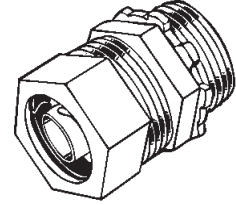

STRAIGHT-UNINSULATED
STEEL/MALLEABLE IRON

ORDERING INFORMATION - DIMENSIONS

STRAIGHT - INSULATED AND UNINSULATED - STEEL/MALLEABLE IRON					
INSULATED IRON CATALOG NUMBER	UNINSULATED IRON CATALOG NUMBER	TRADE SIZE	UNIT CTN. QTY.	SHIP CTN. QTY.	UPC BAR CODE
3511*	—	3/8"	25	100	—
—	3401*	3/8"	50	200	—
3512	3402	1/2"	50	200	—
3512-8	3402-8	1/2"	1	15	
3513	3403	3/4"	25	100	—
3513-8	3403-8	3/4"	1	10	
3514	3404	1"	—	10	—
3514-8	3404-8	1"	1	5	
3515	3505	1-1/4"	—	10	—
3516	3406	1-1/2"	—	5	—
3518	3408	2"	—	5	—
3520	3410	2-1/2"	—	1	—
3522	3412	3"	—	1	—
3524	3414	3-1/2"	—	1	—
3526	3416	4"	—	1	—

*1/2" Trade size hub

DIMENSIONS				
TRADE SIZE	A	B	THREAD SPEC.	C
3/8"	1-1/16"	19/32"	1/2-14 NPT	1-7/16"
1/2"	1-3/16"	19/32"	1/2-14 NPT	1-7/16"
3/4"	1-29/64"	19/32"	3/4-14 NPT	1-9/16"
1"	1-23/32"	21/32"	1-11-1/2 NPT	1-11/16"
1-1/4"	2-3/16"	5/8"	1-1/4-11-1/2 NPT	2-1/32"
1-1/2"	2-1/2"	5/8"	1-1/2-11-1/2 NPT	2-7/32"
2"	3"	21/32"	2-11-1/2 NPT	2-9/32"
2-1/2"	3-5/8"	1"	2-1/2-8 NPT	3-1/2"
3"	4-5/16"	1"	3-8 NPT	3-3/4"
3-1/2"	4-13/16"	1"	3-1/2-8 NPT	3-3/4"
4"	5-5/16"	1"	4-8 NPT	3-3/4"

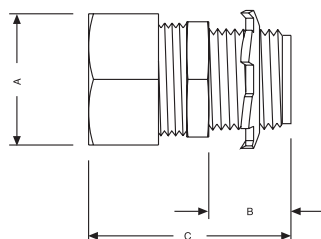

A = Nut Flats
B = Thread length and thread spec.
C = Overall length

LIQUIDTIGHT CONDUIT AND CORD CONNECTORS MALLEABLE IRON - 45 DEGREE CONNECTORS

Applications

- For use in outdoor or indoor locations on flexible metallic liquidtight conduit and Type B flexible nonmetallic liquidtight conduit
- Use to positively bond the conduit to a box or enclosure
- These liquidtight connectors are suitable for use in Class 1, Division 2; Class 2, Division 1 and 2; and Class 3, Division 1 and 2 hazardous locations

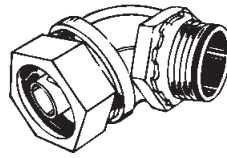

45 DEGREE INSULATED
MALLEABLE IRON

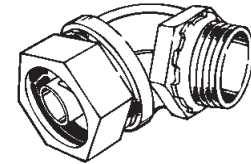

45 DEGREE UNINSULATED
MALLEABLE IRON

Product Features

- Patented split gland-ring is designed to slip onto the conduit quickly and to grip the jacket of the conduit, speeding installation, assuring a perfect seal, and preventing pullouts
- Malleable iron castings mate with other components perfectly without strain or distortion
- All components are reusable — these liquidtight connectors may be easily disassembled and reused after years of service
- Sealing washer (included) provides a liquidtight seal when terminating the connector in a threadless opening
- Heavy duty locknut included with every liquidtight connector assures continuity of ground
- All metallic components are zinc electro plated for added corrosion protection

Compliances

- – Standard 514B
- – C22.2 #18

ORDERING INFORMATION - DIMENSIONS

45 DEGREE - INSULATED AND UNINSULATED- MALLEABLE IRON					
INSULATED IRON CATALOG NUMBER	UNINSULATED IRON CATALOG NUMBER	TRADE SIZE	UNIT CTN. QTY.	SHIP CTN. QTY.	UPC BAR CODE
3561*	3441*	3/8"	—	25	—
3562	3442	1/2"	—	25	—
3563	3443	3/4"	—	25	—
3564	3444	1"	—	10	—
3565	3445	1-1/4"	—	10	—
3566	3446	1-1/2"	—	5	—
3568	3448	2"	—	5	—

*1/2" Trade size hub

DIMENSIONS					
TRADE SIZE	A	B	THREAD SPEC.	C	D
3/8"	1-1/16"	19/32"	1/2-14 NPT	1-3/16"	1-9/32"
1/2"	1-3/16"	19/32"	1/2-14 NPT	1-3/16"	1-9/32"
3/4"	1-29/64"	19/32"	3/4-14 NPT	1-3/16"	1-7/16"
1"	1-23/32"	21/32"	1-11-1/2 NPT	1-3/8"	1-17/32"
1-1/4"	2-3/16"	5/8"	1-1/4-11-1/2 NPT	1-27/64"	1-11/16"
1-1/2"	2-1/2"	5/8"	1-1/2-11-1/2 NPT	1-21/32"	2"
2"	3"	21/32"	2-11-1/2 NPT	1-11/16"	2-1/4"

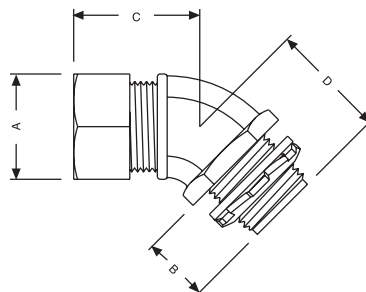

A = Nut Flats
B = Thread length and thread spec.
C = Thread to bend
D = Nut to bend

LIQUIDTIGHT CONDUIT AND CORD CONNECTORS MALLEABLE IRON - 90 DEGREE CONNECTORS



Applications

- For use in outdoor or indoor locations on flexible metallic liquidtight conduit and Type B flexible nonmetallic liquidtight conduit
- Use to positively bond the conduit to a box or enclosure
- These liquidtight connectors are suitable for use in Class 1, Division 2; Class 2, Division 1 and 2; and Class 3, Division 1 and 2 hazardous locations

Product Features

- Patented split gland-ring is designed to slip onto the conduit quickly and to grip the jacket of the conduit, speeding installation, assuring a perfect seal, and preventing pullouts
- Malleable iron castings mate with other components perfectly without strain or distortion
- All components are reusable — these liquidtight connectors may be easily disassembled and reused after years of service
- Sealing washer (included) provides a liquidtight seal when terminating the connector in a threadless opening
- Heavy duty locknut included with every liquidtight connector assures continuity of ground
- All metallic components are zinc electro plated for added corrosion protection
- UPC bar coded fittings are individually polybagged with a preprinted UPC-A bar code and packaged in pre-scored tear top cartons for an attractive presentation

Compliances

-  – Standard 514B
-  – C22.2 #18

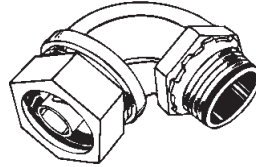

90 DEGREE INSULATED
MALLEABLE IRON

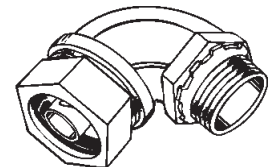

90 DEGREE - UNINSULATED
MALLEABLE IRON

ORDERING INFORMATION - DIMENSIONS

90 DEGREE - INSULATED AND UNINSULATED- MALLEABLE IRON					
INSULATED IRON CATALOG NUMBER	UNINSULATED IRON CATALOG NUMBER	TRADE SIZE	UNIT CTN. QTY.	SHIP CTN. QTY.	UPC BAR CODE
3541*	3421*	3/8"	25	100	—
3542	3422	1/2"	25	100	—
3542-8	3422-8	1/2"	1	15	
3543	3423	3/4"	25	100	—
3543-8	3423-8	3/4"	1	10	
3544	3424	1"	—	10	—
3544-8	3424-8	1"	1	5	
3545	3425	1-1/4"	—	10	—
3546	3426	1-1/2"	—	5	—
3548	3428	2"	—	5	—
3550	3430	2-1/2"	—	1	—
3552	3432	3"	—	1	—
3556	3436	4"	—	1	—

*1/2" Trade size hub

DIMENSIONS					
TRADE SIZE	A	B	THREAD SPEC.	C	D
3/8"	1-1/16"	19/32"	1/2-14 NPT	1-5/16"	1-7/16"
1/2"	1-3/16"	19/32"	1/2-14 NPT	1-5/16"	1-1/16"
3/4"	1-29/64"	19/32"	3/4-14 NPT	1-7/16"	1-5/8"
1"	1-23/32"	21/32"	1-11-1/2 NPT	1-25/32"	2-3/16"
1-1/4"	2-3/16"	5/8"	1-1/4-11-1/2 NPT	1-31/32"	2-1/2"
1-1/2"	2-1/2"	5/8"	1-1/2-11-1/2 NPT	2-3/16"	2-11/16"
2"	3"	21/32"	2-11-1/2 NPT	2-17/32"	3-1/4"
2-1/2"	3-5/8"	1"	2-1/2-8 NPT	3-3/8"	4-1/4"
3"	4-5/16"	1"	3-8 NPT	3-11/16"	4-7/8"
4"	5-5/16"	1"	4-8 NPT	4-3/16"	5-5/8"

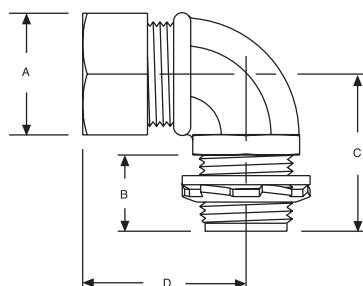

A = Nut Flats
B = Thread length and thread spec.
C = Thread to bend
D = Nut to bend

LIQUIDTIGHT CONDUIT AND CORD CONNECTORS STEEL/MALLEABLE IRON - STRAIGHT CONNECTORS GROUNDING TYPE



Applications

- For use in outdoor or indoor locations on flexible metallic liquidtight conduit, when installation of a copper or aluminum external bonding jumper is required
- These grounding liquidtight connectors are suitable for use in Class 1, Division 2; Class 2, Division 1 and 1; and Class 3, Division 1 and 2 hazardous locations

Product Features

- Patented split gland-ring is designed to slip onto the conduit quickly and to grip the jacket of the conduit, speeding installation, assuring a perfect seal, and preventing pullouts
- Screw machined bodies (straight through 1") and precision threaded malleable iron castings mate with other components perfectly without strain or distortion
- All components are reusable — these liquidtight connectors may be easily disassembled and reused after years of service
- Sealing washer (included) provides a liquidtight seal when terminating the connector in a threadless opening
- Heavy duty locknut included with every liquidtight connector assures continuity of ground
- All metallic components are zinc electro plated for added corrosion protection

Compliances

-  - Standard 514B
-  - C22.2 #18

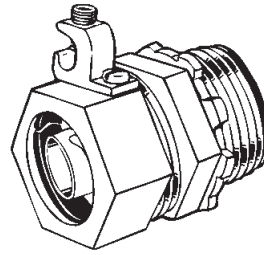

**STRAIGHT - INSULATED
WITH GROUND LUG
STEEL/MALLEABLE IRON**

ORDERING INFORMATION - DIMENSIONS

STRAIGHT - INSULATED WITH GROUND LUG STEEL/MALLEABLE IRON						
CATALOG NUMBER	TRADE SIZE	UNIT. CTN. QTY.	SHIP' CTN. QTY.	GROUNDING WIRE CAPACITY		UPC BAR CODE
				MIN.	MAX.	
3511-3*	3/8"	—	25	#14 SOL.	#4 STR.	—
3512-3	1/2"	—	25	#14 SOL.	#4 STR.	—
3513-3	3/4"	—	25	#14 SOL.	#4 STR.	—
3514-3	1"	—	10	#14 SOL.	#4 STR.	—
3515-3	1-1/4"	—	10	#14 SOL.	#4 STR.	—
3516-3	1-1/2"	—	5	#14 SOL.	#4 STR.	—
3518-3	2"	—	5	#14 SOL.	#4 STR.	—
3520-3	2-1/2"	—	1	#14 SOL.	#110 STR.	—
3522-3	3"	—	1	#14 SOL.	#110 STR.	—
3524-3	3-1/2"	—	1	#6 STR.	#250 MCM	—
3526-3	4"	—	1	#6 STR.	#250 MCM	—

*1/2" Trade size hub

DIMENSIONS					
TRADE SIZE	A	B	THREAD SPEC.	C	D
3/8"	1-3/16"	19/32"	1/2-14 NPT	1-7/16"	25/32"
1/2"	1-5/16"	19/32"	1/2-14 NPT	1-7/16"	25/32"
3/4"	1-9/16"	19/32"	3/4-14 NPT	1-9/16"	25/32"
1"	1-27/32"	21/32"	1-11-1/2 NPT	1-11/16"	25/32"
1-1/4"	2-3/16"	5/8"	1-1/4-11-1/2 NPT	2-1/32"	25/32"
1-1/2"	2-1/2"	5/8"	1-1/2-11-1/2 NPT	2-7/32"	25/32"
2"	3"	2-1/32"	2-11-1/2 NPT	2-9/32"	25/32"
2-1/2"	3-5/8"	1"	2-1/2-8 NPT	3-1/2"	1-11/64"
3"	4-5/16"	1"	3-8 NPT	3-3/4"	1-11/64"
3-1/2"	4-13/16"	1"	3-1/2-8 NPT	3-3/4"	1-57/64"
4"	5-5/16"	1"	4-8 NPT	3-3/4"	1-57/64"

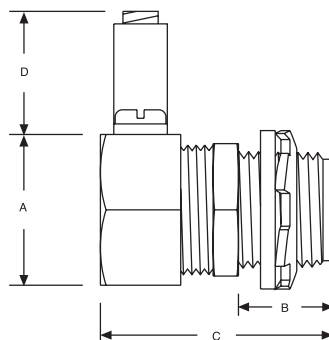

A= Nut Flats
B = Thread length and thread spec.
C = Overall length
D = Lug height

LIQUIDTIGHT CONDUIT AND CORD CONNECTORS STEEL/MALLEABLE IRON - 45 DEGREE CONNECTORS GROUNDING TYPE

Applications

- For use in outdoor or indoor locations on flexible metallic liquidtight conduit, when installation of a copper or aluminum external bonding jumper is required
- These grounding liquidtight connectors are suitable for use in Class 1, Division 2; Class 2, Division 1 and 1; and Class 3, Division 1 and 2 hazardous locations

Product Features

- Patented split gland-ring is designed to slip onto the conduit quickly and to grip the jacket of the conduit, speeding installation, providing a liquidtight seal, and preventing pullouts
- Malleable iron castings mate with other components perfectly without strain or distortion
- All components are reusable — these liquidtight connectors may be easily disassembled and reused after years of service
- Sealing washer (included) provides a liquidtight seal when terminating the connector in a threadless opening
- Heavy duty locknut included with every liquidtight connector assures continuity of ground
- All metallic components are zinc electro plated for added corrosion protection

Compliances

-  – Standard 514B
-  – C22.2 #18

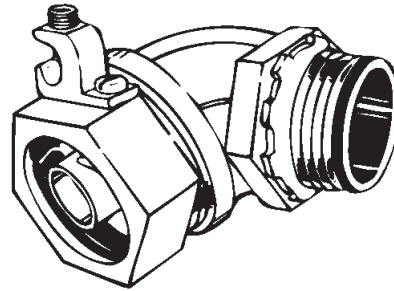

45 DEGREE - INSULATED
WITH GROUND LUG
MALLEABLE IRON

ORDERING INFORMATION - DIMENSIONS

STRAIGHT - INSULATED WITH GROUND LUG STEEL/MALLEABLE IRON						
CATALOG NUMBER	TRADE SIZE	UNIT. CTN. QTY.	SHIP CTN. QTY.	GROUNDING WIRE CAPACITY		UPC BAR CODE
				MIN.	MAX.	
3561-3*	3/8"	—	25	#14 SOL.	#4 STR.	—
3562-3	1/2"	—	25	#14 SOL.	#4 STR.	—
3563-3	3/4"	—	25	#14 SOL.	#4 STR.	—
3564-3	1"	—	10	#14 SOL.	#4 STR.	—
3565-3	1-1/4"	—	10	#14 SOL.	#4 STR.	—
3566-3	1-1/2"	—	5	#14 SOL.	#4 STR.	—
3568-3	2"	—	5	#14 SOL.	#4 STR.	—

*1/2" Trade size hub

DIMENSIONS						
TRADE SIZE	A	B	THREAD SPEC.	C	D	E
3/8"	1-3/16"	19/32"	1/2-14 NPT	1-3/16"	1-9/32"	25/32"
1/2"	1-5/16"	19/32"	1/2-14 NPT	1-3/16"	1-9/32"	25/32"
3/4"	1-9/16"	19/32"	3/4-14 NPT	1-3/16"	1-7/16"	25/32"
1"	1-27/32"	21/32"	1-11-1/2 NPT	1-3/8"	1-17/32"	25/32"
1-1/4"	2-3/16"	5/8"	1-1/4-11-1/2 NPT	1-27/64"	1-11/16"	25/32"
1-1/2"	2-1/2"	5/8"	1-1/2-11-1/2 NPT	1-21/32"	2"	25/32"
2"	3"	21/32"	2-11-1/2 NPT	1-11/16"	2-1/4"	25/32"

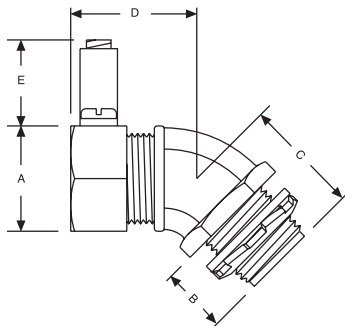

A = Nut Flats
B = Thread length and thread spec.
C = Thread to bend
D = Nut to bend
E = Lug height

LIQUIDTIGHT CONDUIT AND CORD CONNECTORS STEEL/MALLEABLE IRON - 90 DEGREE CONNECTORS GROUNDING TYPE

Applications

- For use in outdoor or indoor locations on flexible metallic liquidtight conduit, when installation of a copper or aluminum external bonding jumper is required
- These grounding liquidtight connectors are suitable for use in Class 1, Division 2; Class 2, Division 1 and 1; and Class 3, Division 1 and 2 hazardous locations

Product Features

- Patented split gland-ring is designed to slip onto the conduit quickly and to grip the jacket of the conduit, speeding installation, providing a liquidtight seal, and preventing pullouts
- Malleable iron castings mate with other components perfectly without strain or distortion
- All components are reusable — these liquidtight connectors may be easily disassembled and reused after years of service
- Sealing washer (included) provides a liquidtight seal when terminating the connector in a threadless opening
- Heavy duty locknut included with every liquidtight connector assures continuity of ground
- All metallic components are zinc electro plated for added corrosion protection

Compliances

-  - Standard 514B
-  - C22.2 #18

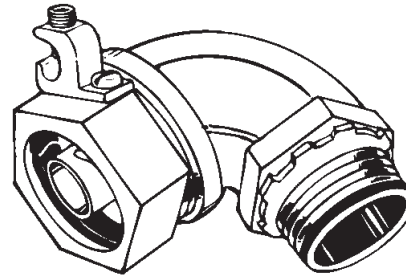

90 DEGREE - INSULATED
WITH GROUND LUG
MALLEABLE IRON

ORDERING INFORMATION - DIMENSIONS

STRAIGHT - INSULATED WITH GROUND LUG STEEL/MALLEABLE IRON						
CATALOG NUMBER	TRADE SIZE	UNIT. CTN. QTY.	SHIP CTN. QTY.	GROUNDING WIRE CAPACITY		UPC BAR CODE
				MIN.	MAX.	
3541-3*	3/8"	—	25	#14 SOL.	#4 STR.	—
3542-3	1/2"	—	25	#14 SOL.	#4 STR.	—
3543-3	3/4"	—	25	#14 SOL.	#4 STR.	—
3544-3	1"	—	10	#14 SOL.	#4 STR.	—
3545-3	1-1/4"	—	10	#14 SOL.	#4 STR.	—
3546-3	1-1/2"	—	5	#14 SOL.	#4 STR.	—
3548-3	2"	—	5	#14 SOL.	#4 STR.	—
3550-3	2-1/2"	—	1	#14 SOL.	#4 STR.	—
3552-3	3"	—	1	#14 SOL.	#4 STR.	—
3556-3	4"	—	1	#14 SOL.	#4 STR.	—

*1/2" Trade size hub

DIMENSIONS						
TRADE SIZE	A	B	THREAD SPEC.	C	D	E
3/8"	1-3/16"	19/32"	1/2-14 NPT	1 5/16"	1-7/16"	25/32"
1/2"	1-5/16"	19/32"	1/2-14 NPT	1-5/16"	1-7/16"	25/32"
3/4"	1-9/16"	19/32"	3/4-14 NPT	1-7/16"	1-5/8"	25/32"
1"	1-27/32"	21/32"	1-11-1/2 NPT	1-25/32"	2-3/16"	25/32"
1-1/4"	2-3/16"	5/8"	1-1/4-11-1/2 NPT	1-31/32"	2-1/2"	25/32"
1-1/2"	2-1/2"	5/8"	1-1/2-11-1/2 NPT	2-3/16"	2-11/16"	25/32"
2"	3"	21/32"	2-11-1/2 NPT	2-17/32"	3-1/4"	25/32"
2-1/2"	3-5/8"	1"	2-1/2-8 NPT	3-3/8"	4-1/4"	1-11/64"
3"	4-5/16"	1"	3-8 NPT	3-11/16"	4-7/8"	1-11/64"
4"	5-5/16"	1"	4-8 NPT	4-3/16"	5-5/8"	1-57/64"

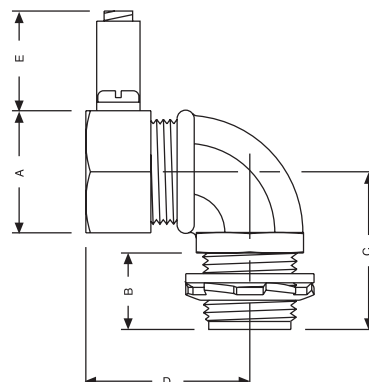

A = Nut Flats
B = Thread length and thread spec.
C = Thread to bend
D = Nut to bend
E = Lug height

LIQUIDTIGHT CONDUIT AND CORD CONNECTORS STEEL - SEALING WASHERS

Application

- For use whenever a positive seal is required between the shoulder of a fitting and an enclosure

Product Features

- One-piece construction assures proper installation — no need to worry about aligning multiple components
- Steel ring is zinc electro plated for added corrosion protection
- UPC bar coded fittings are individually polybagged with a preprinted UPC-A bar code and packaged in pre-scored tear top cartons for an attractive presentation

Compliances

-  – Standard 514B
-  – C22.2 #18



SEALING WASHERS*

ORDERING INFORMATION - DIMENSIONS

SEALING WASHERS*				
CATALOG NUMBER	TRADE SIZE	UNIT. CTN. QTY.	SHIP. CTN. QTY.	UPC BAR CODE
2452	1/2"	50	100	—
2452-8	1/2"	2	25	
2453	3/4"	25	50	—
2453-8	3/4"	2	20	
2454	1"	25	50	—
2454-8	1"	2	10	
2455	1-1/4"	5	25	—
2456	1-1/2"	5	25	—
2458	2"	5	25	—

*One-piece steel ring and neoprene gasket, raintight

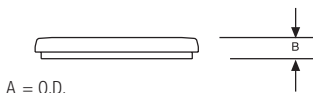
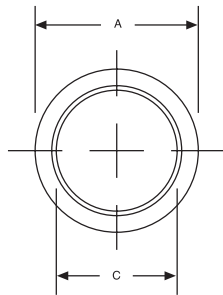

A = O.D.
B = I.D.
C = Thickness

DIMENSIONS*			
CONDUIT SIZE	A	B	C
1/2"	1-5/64"	5/64"	51/64"
3/4"	1-11/32"	5/32"	1"
1"	1-5/8"	11/64"	1-1/4"
1-1/4"	2"	11/64"	1-39/64"
1-1/2"	2-23/64"	3/16"	1-27/32"
2"	2-53/64"	3/16"	2-5/16"

*Dimensions when ring and gasket are together

LIQUIDTIGHT CONDUIT AND CORD CONNECTORS NONMETALLIC - TYPE B CONDUIT AND CONNECTORS



Applications

- For use in dry or wet locations when the conduit and fittings are not subject to physical damage
- Use Type B conduit and fittings whenever flexibility is required for installation, operation, or maintenance

Product Features

- All gray nonmetallic construction ends metal fatigue and separation problems
- Conduit cuts cleanly — speeds installation and ends the worry of jagged edges
- Each connector is supplied with a Neoprene o-ring and nylon locknut
- UPC bar coded fittings are individually polybagged with a preprinted UPC-A bar code and packaged in pre-scored tear top cartons for an attractive presentation

Compliances

-  – Standard 1660 (conduit); Standard 514B (fittings)
-  – C22.2 #18

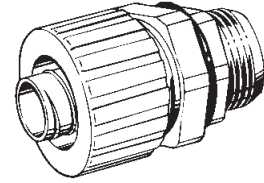
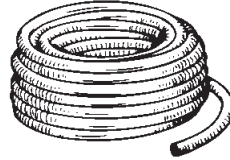

TYPE B LIQUIDTIGHT FLEXIBLE
NONMETALLIC CONDUIT

STRAIGHT CONNECTORS -
NYLON FOR TYPE B CONDUIT

ORDERING INFORMATION - DIMENSIONS

TYPE B LIQUIDTIGHT FLEXIBLE - NONMETALLIC CONDUIT			
CATALOG NUMBER	TRADE SIZE	FEET PER PACKAGE	UPC BAR CODE
6701	3/8"	100	—
6702	1/2"	100	—
6703	3/4"	100	—
6704	1"	100	—
6705	1-1/4"	100	—
6706	1-1/2"	50	—
6708	2"	50	—

STRAIGHT CONNECTORS - NYLON - FOR TYPE B CONDUIT				
CATALOG NUMBER	TRADE SIZE	UNIT. CTN. QTY.	SHIP. CTN. QTY.	UPC BAR CODE
4721*	3/8"	—	25	—
4722	1/2"	—	25	—
4722-8	1/2"	1	20	■
4723	3/4"	—	25	—
4723-8	3/4"	1	15	■
4724	1"	—	10	—
4724-8	1"	1	10	■
4725	1-1/4"	—	10	—
4726	1-1/2"	—	5	—
4728	2"	—	5	—

*1/2" Trade size hub

DIMENSIONS		
Type B Liquidtight Flexible Nonmetallic Conduit Dimensions		
TRADE SIZE	CONDUIT I.D./O.D.	BEND RADIUS
3/8"	.49/.70"	2.00"
1/2"	.63/.83"	3.00"
3/4"	.83/1.04"	4.00"
1"	1.05/1.30"	5.00"
1-1/4"	1.40/1.65"	6.30"
1-1/2"	1.59/1.88"	7.50"
2"	2.03/2.36"	10.00"

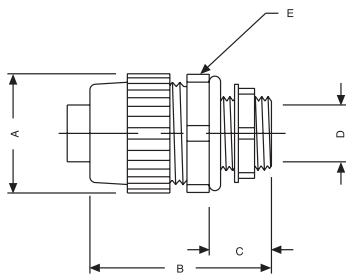

DIMENSIONS						
TRADE SIZE	A	B	C	D	E	
					A/C*	A/F**
3/8"	1.14"	1.63"	.57"	.42"	1.41"	1.30"
1/2"	1.30"	2.14"	.57"	.55"	1.41"	1.30"
3/4"	1.53"	2.22"	.58"	.74"	1.85"	1.53"
1"	1.80"	2.32"	.72"	.96"	1.94"	1.80"
1-1/4"	2.20"	2.15"	.74"	1.30"	2.38"	2.18"
1-1/2"	2.49"	2.35"	.76"	1.46"	2.63"	2.43"
2"	3.05"	2.51"	.79"	1.90"	3.13"	2.93"

* A/C=Across corners
**A/F=Across flats

LIQUIDTIGHT CONDUIT AND CORD CONNECTORS NONMETALLIC - SWIVEL LOK® CONNECTORS FOR TYPE B NONMETALLIC CONDUIT

Swivel Lok® and 90 Degree Connectors Applications

- For use in dry or wet locations when the conduit and fittings are not subject to physical damage
- Use Type B conduit and fittings whenever flexibility is required for installation, operation, or maintenance



Swivel Lok® and 90 Degree Connectors Product Features

- All gray nonmetallic construction provides superior corrosion resistance
- Each connector is supplied with a Neoprene O-ring and nylon gasket

Swivel Lok® Connectors Product Features

- Swivel Lok®, multi-position connector (trade sizes 3/8" to 1") twists from 0° to 90°, easing installation in difficult locations and eliminating need to stock other angle connectors
- UPC bar coded fittings are individually polybagged with a preprinted UPC-A bar code and packaged in pre-scored tear top cartons for an attractive presentation

Swivel Lok® and 90 Degree Connectors Compliances

-  - Standard 514B
-  - C22.2 #18

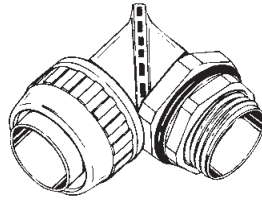

SWIVEL LOK® MULTI - POSITION CONNECTORS NYLON - FOR TYPE B CONDUIT

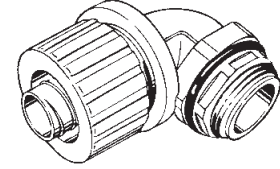

90 DEGREE CONNECTORS NYLON TYPE B CONDUIT

ORDERING INFORMATION - DIMENSIONS

SWIVEL LOK® MULTI - POSITION CONNECTORS - NYLON FOR TYPE B CONDUIT				
CATALOG NUMBER	TRADE SIZE	UNIT. CTN. QTY.	SHIP. CTN. QTY.	UPC BAR CODE
4731*	3/8"	—	25	—
4732	1/2"	—	25	—
4732-8	1/2"	1	20	
4733	3/4"	—	25	—
4733-8	3/4"	1	15	
4734	1"	—	10	—
4734-8	1"	1	10	

*1/2" Trade size hub

DIMENSIONS							
TRADE SIZE	F	G	H		I	J	K
			A/C*	A/F**			
3/8"	3.27"	.57"	1.41"	1.30"	1.30"	1.43"	2.00"
1/2"	3.27"	.57"	1.41"	1.30"	1.30"	1.43"	2.00"
3/4"	3.66"	.58"	1.65"	1.53"	1.53"	1.59"	2.23"
1"	4.00"	.72"	1.94"	1.80"	1.80"	1.84"	2.30"

* A/C=Across corners
** A/F=Across flats

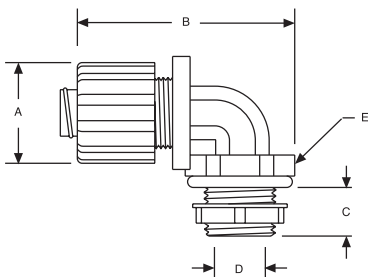

90 DEGREE CONNECTORS - NYLON - TYPE B CONDUIT				
CATALOG NUMBER	TRADE SIZE	UNIT. CTN. QTY.	SHIP. CTN. QTY.	UPC BAR CODE
4735	1-1/4"	—	10	—

DIMENSIONS						
TRADE SIZE	A	B	C	D	E	
					A/C*	A/F**
1-1/4"	2.21"	3.57"	.74"	1.30"	2.38"	2.18"

* A/C=Across corners
** A/F=Across flats

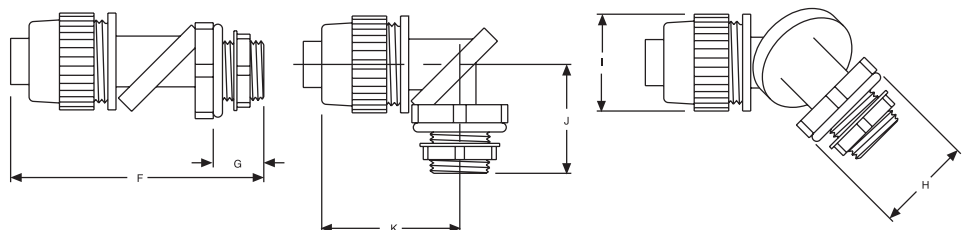

LIQUIDTIGHT CONDUIT AND CORD CONNECTORS NONMETALLIC - EXTRA FLEXIBLE TUBING AND CONNECTORS



Applications

- For use in dry or wet locations when the conduit and fittings are not subject to physical damage
- Use extra flexible tubing and connectors whenever added flexibility is required for installation, operation, or maintenance

Product Features

- All black nonmetallic construction ends metal fatigue and separation problems
- Conduit cuts cleanly - speeds installation and ends the worry of jagged edges
- Each connector is supplied with a Neoprene O-ring and nylon gasket

Compliances

-  - Recognized (tubing)
-  - C22.2 #18 (tubing & fitting)
-  - Standard 514B (fitting)

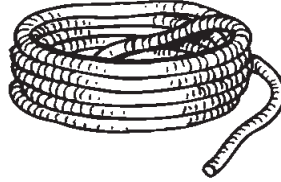

EXTRA FLEXIBLE LIQUIDTIGHT
NONMETALLIC TUBING

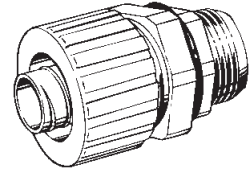

STRAIGHT CONNECTORS
NYLON FOR EXTRA FLEXIBLE
TUBING

ORDERING INFORMATION - DIMENSIONS

EXTRA FLEXIBLE LIQUIDTIGHT - NONMETALLIC TUBING			
CATALOG NUMBER	TRADE SIZE	FEET PER PACKAGE	UPC BAR CODE
6711	3/8"	100	—
6712	1/2"	100	—
6713	3/4"	100	—
6714	1"	100	—
6715	1-1/4"	100	—
6716	1-1/2"	50	—
6718	2"	50	—

DIMENSIONS		
Extra Flexible Liquidtight Nonmetallic Tubing Dimensions		
TRADE SIZE	CONDUIT I.D./O.D.	BEND RADIUS
3/8"	.49/.70"	2.00"
1/2"	.63/.83"	3.00"
3/4"	.83/1.04"	4.00"
1"	1.05/1.30"	5.00"
1-1/4"	1.40/1.65"	6.30"
1-1/2"	1.59/1.88"	7.50"
2"	2.03/2.36"	10.00"

STRAIGHT CONNECTORS - NYLON - FOR EXTRA FLEXIBLE TUBING				
CATALOG NUMBER	TRADE SIZE	UNIT. CTN. QTY.	SHIP. CTN. QTY.	UPC BAR CODE
4741*	3/8"	—	25	—
4742	1/2"	—	25	—
4743	3/4"	—	25	—
4744	1"	—	10	—
4745	1-1/4"	—	10	—
4746	1-1/2"	—	5	—
4748	2"	—	5	—

*1/2" Trade size hub

DIMENSIONS - STRAIGHT CONNECTORS - NYLON - FOR EXTRA FLEXIBLE TUBING						
TRADE SIZE	A	B	C	D	E	
					A/C*	A/F**
3/8"	1.14"	1.63"	.57"	.42"	1.41"	1.30"
1/2"	1.30"	2.14"	.57"	.55"	1.41"	1.30"
3/4"	1.53"	2.22"	.58"	.74"	1.85"	1.53"
1"	1.80"	2.32"	.72"	.96"	1.94"	1.80"
1-1/4"	2.20"	2.15"	.74"	1.30"	2.38"	2.18"
1-1/2"	2.49"	2.35"	.76"	1.46"	2.63"	2.43"
2"	3.05"	2.51"	.79"	1.90"	3.13"	2.93"

* A/C=Across corners

** A/F=Across flats

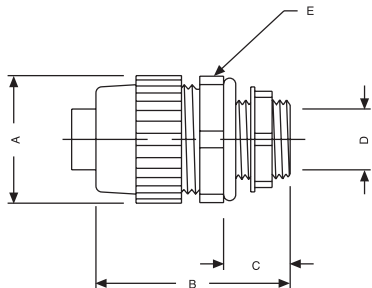

LIQUIDTIGHT CONDUIT AND CORD CONNECTORS NONMETALLIC - SWIVEL LOK® CONNECTORS FOR EXTRA FLEXIBLE TUBING



Applications

- For use in dry or wet locations when the conduit and fittings are not subject to physical damage
- Use extra flexible tubing and connectors whenever added flexibility is required for installation, operation, or maintenance

Product Features

- All black nonmetallic construction ends metal fatigue and separation problems
- Swivel Lok®, multi-position connector (trade sizes 3/8" to 1") twists from 0° to 90°, easing installation in difficult locations and eliminating need to stock other angle connectors

Compliances

-  - Standard 514B
-  - C22.2 #18

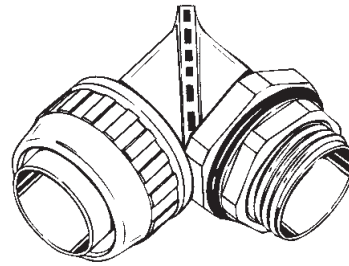

SWIVEL LOK® MULTI - POSITION CONNECTORS NYLON
FOR EXTRA FLEXIBLE TUBING

ORDERING INFORMATION - DIMENSIONS

SWIVEL LOK® MULTI - POSITION CONNECTORS - NYLON FOR EXTRA FLEXIBLE TUBING				
CATALOG NUMBER	TRADE SIZE	UNIT. CTN. QTY.	SHIP. CTN. QTY.	UPC BAR CODE
4751*	3/8"	—	25	—
4752	1/2"	—	25	—
4753	3/4"	—	25	—
4754	1"	—	10	—

*1/2" Trade size hub

DIMENSIONS							
TRADE SIZE	A	B	C		D	E	F
			A/C*	A/F**			
3/8"	3.27"	.57"	1.41"	1.30"	1.30"	1.43"	2.00"
1/2"	3.27"	.57"	1.41"	1.30"	1.30"	1.43"	2.00"
3/4"	3.66"	.58"	1.65"	1.53"	1.53"	1.59"	2.23"
1"	4.00"	.72"	1.94"	1.80"	1.80"	1.84"	2.30"

* A/C=Across corners

** A/F=Across flats

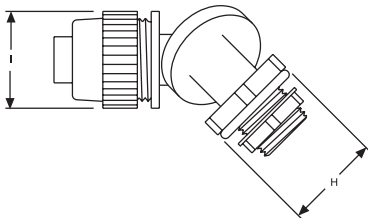
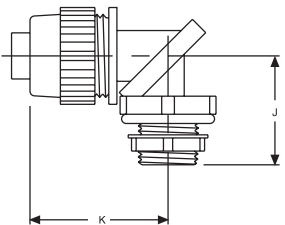
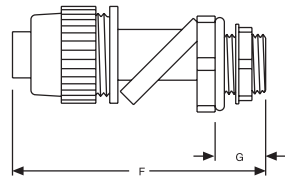

LIQUIDTIGHT CONDUIT AND CORD CONNECTORS

NONMETALLIC - 90 DEGREE CONNECTOR FOR EXTRA FLEXIBLE TUBING AND CONDUIT CONNECTOR KIT WITH SWIVEL-LOK® MULTI-POSITION CONNECTOR

90 Degree Connector and Conduit and Conductor Kit Application

- For use in wet or dry locations when the conduit and fittings are not subject to physical damage

90 Degree Connector Application

- Use extra flexible tubing and connectors whenever added flexibility is required for installation, operation or maintenance

Conduit and Connector Kit Application

- Use these conduit and connector kits whenever flexibility is required for installation, operation, or maintenance



90 Degree Connector Product Features

- All black nonmetallic construction provides corrosion protection
- Each connector is supplied with a Neoprene o-ring and nylon gasket



Conduit and Connector Kit Product Features

- All gray nonmetallic construction ends metal fatigue and separation problems
- Each kit contains all components necessary for installation — no need to worry about mismatched components
- Convenient to use
- These conduit and connector kits are ideal for air conditioners, swimming pools, lighting, hot tub and heat pump installation
- UPC bar coded fittings are individually polybagged with a preprinted UPC-A bar code and packaged in pre-scored tear top cartons for an attractive presentation

90 Degree Connector Compliances

-  - Standard 514B
-  - C22.2 #18

Conduit and Connector Kit Compliances

-  - Standard 1660 (conduit); Standard 514B (fittings)
-  - C22.2 #18

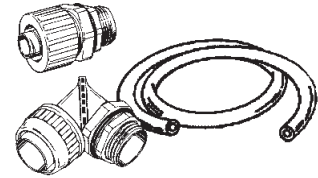
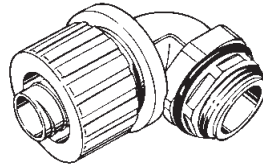

90 DEGREE CONNECTORS
NYLON FOR EXTRA
FLEXIBLE TUBING



CONDUIT AND
CONNECTOR KIT*

ORDERING INFORMATION - DIMENSIONS

90 DEGREE CONNECTORS - NYLON FOR EXTRA FLEXIBLE TUBING				
CATALOG NUMBER	TRADE SIZE	UNIT. CTN. QTY.	SHIP. CTN. QTY.	UPC BAR CODE
4755	1-1/4"	—	10	—

DIMENSIONS						
TRADE SIZE	A	B	C	D	E	
					A/C*	A/F**
1-1/4"	2.21"	3.57"	.74"	1.30"	2.38"	2.18"

* A/C=Across corners
** A/F=Across flats

CONDUIT AND CONNECTOR KIT*				
CATALOG NUMBER	TRADE SIZE	UNIT. CTN. QTY.	SHIP. CTN. QTY.	UPC BAR CODE
6702-9	1/2"	1	5	
6703-9	3/4"	1	5	

*Kit contains 6 foot length of Type B conduit, one straight and one Swivel Lok® connector

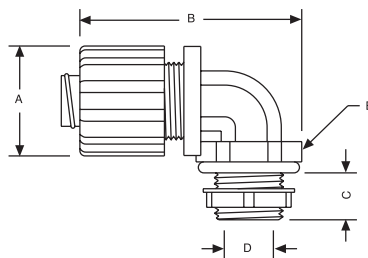

LIQUIDTIGHT CONDUIT AND CORD CONNECTORS STEEL/MALLEABLE IRON - STRAIN RELIEF CORD CONNECTORS

Applications

- For use in wet or dry locations to provide a liquidtight and strain relief termination for flexible cord and cable
- These liquidtight strain relief cord connectors are suitable for use in Class 1, Division 2; Class 2, Division 1 and 2; and Class 3, Division 1 and 2 hazardous locations

Product Features

- All steel/malleable construction provides mechanical strength
- Screw machined bodies (straights through 1") and precision threaded malleable iron castings mate with other components without strain or distortion
- Unique Neoprene grommet design — grommet is forced up and around the cord when the nut is tightened for a positive liquidtight seal
- Washers have size range imprinted for identification — eliminates misidentifying inventory
- Use locknuts and sealing washers to complete a liquidtight installation on a sheet metal box or panel
- All metallic components are zinc electro plated for corrosion protection
- UPC bar coded fittings are individually polybagged with a preprinted UPC-A bar code and packaged in pre-scored tear top cartons for an attractive presentation

Compliance

-  - Standard 514B

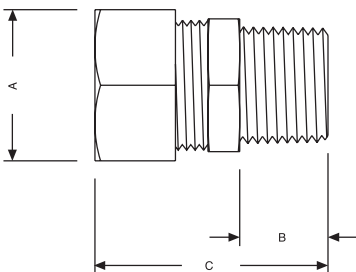

A = Nut Flats
B = Thread length and thread spec.
C = Overall length

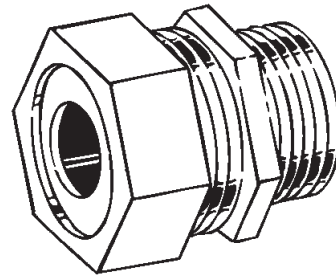

STRAIGHT CONNECTORS
STEEL - MALLEABLE IRON

ORDERING INFORMATION - DIMENSIONS

STRAIGHT CONNECTORS - STEEL - MALLEABLE IRON				
CATALOG NUMBER	CABLE RANGE	UNIT CTN. QTY.	SHIP CTN. QTY.	UPC BAR CODE
1/2" HUBS - FORM 1				
3702-1	.125 -.250	—	25	—
3702-2	.250 -.375	—	25	—
3782-2	.250 -.375	1	15	
3702-3	.375 -.425	—	25	—
3702-4	.425 -.500	—	25	—
1/2" HUBS - FORM 2				
3702-5	.375 -.500	—	25	—
3782-5	.375 -.500	1	15	
3702-6	.500 -.600	—	25	—
3782-6	.500 -.600	1	15	
3/4" HUBS - FORM 3				
3703-1	.250 -.375	—	25	—
3703-2	.375 -.500	—	25	—
3703-3	.500 -.600	—	25	—
3703-4	.600 -.650	—	25	—
3703-6	.650 -.700	—	25	—
3703-5	.700 -.850	—	25	—
1" HUBS - FORM 4				
3704-1	.600 -.700	—	25	—
3704-2	.700 -.850	—	25	—
3704-3	.850 -1.000	—	25	—
1 1/4" HUBS - FORM 5				
3705-1	.850 -1.000	—	25	—
3705-2	1.000 -1.250	—	25	—
3705-3	1.250 -1.400	—	25	—
1 1/2" HUBS - FORM 6				
3706-1	1.000 -1.250	—	10	—
3706-2	1.250 -1.400	—	10	—

DIMENSIONS

HUB SIZE	SIZE	FORM A	THREAD SPEC.	B	C
1/2"	F1	1-1/16"	1/2-14 NPT	19/32"	1-7/16"
1/2"	F2	1-3/16"	1/2-14 NPT	19/32"	1-7/16"
3/4"	F3	1-29/64"	3/4-14 NPT	19/32"	1-9/16"
1"	F4	1-23/32"	1-11-1/2 NPT	21/32"	1-11/16"
1-1/4"	F5	2-3/16"	1-1/4-11-1/2 NPT	5/8"	2-1/32"
1-1/2"	F6	2-1/2"	1-1/2-11-1/2 NPT	5/8"	2-7/32"

LIQUIDTIGHT CONDUIT AND CORD CONNECTORS

MALLEABLE IRON - 90 DEGREE STRAIN RELIEF CORD CONNECTORS

Applications

- For use in wet or dry locations to provide a liquidtight and strain relief termination for flexible cord and cable
- These liquidtight strain relief cord connectors are suitable for use in Class 1, Division 2; Class 2, Division 1 and 2; and Class 3, Division 1 and 2 hazardous locations

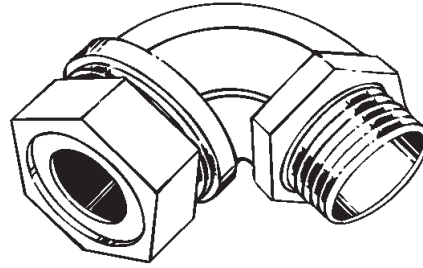

90 DEGREE CONNECTORS
MALLEABLE IRON

Product Features

- All steel/malleable construction provides mechanical strength
- Malleable iron castings mate with other components without strain or distortion
- Unique Neoprene grommet design — grommet is forced up and around the cord when the nut is tightened for a positive liquidtight seal
- Washers have size range imprinted for identification — eliminates misidentifying inventory
- Use locknuts and sealing washers to complete a liquidtight installation on a sheet metal box or panel
- All metallic components are zinc electro plated for corrosion protection

Compliance

-  - Standard 514B

ORDERING INFORMATION - DIMENSIONS

90 DEGREE CONNECTORS - MALLEABLE IRON			
CATALOG NUMBER	CABLE RANGE	SHIP CTN. QTY.	UPC BAR CODE
1/2" HUBS - FORM 1			
3792-1	.125 - .250	25	—
3792-2	.250 - .375	25	—
3792-3	.375 - .425	25	—
3792-4	.425 - .500	25	—
1/2" HUBS - FORM 2			
3792-5	.375 - .500	25	—
3792-6	.500 - .600	25	—
3/4" HUBS - FORM 3			
3793-1	.250 - .375	10	—
3793-2	.375 - .500	10	—
3793-3	.500 - .600	10	—
3793-4	.600 - .650	10	—
3793-6	.650 - .700	10	—
3793-5	.700 - .850	10	—

DIMENSIONS						
HUB SIZE	SIZE	FORM A	THREAD SPEC.	B	C	D
1/2"	F1	1-1/16"	1/2-14 NPT	19/32"	1-5/16"	1-7/16"
1/2"	F2	1-3/16"	1/2-14 NPT	19/32"	1-5/16"	1-7/16"
3/4"	F3	1-29/64"	3/4-14 NPT	19/32"	1-7/16"	1-5/8"

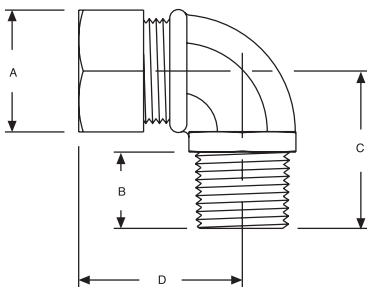

- A = Nut Flats
B = Thread length and thread spec.
C = Thread to bend
D = Nut to bend

LIQUIDTIGHT CONDUIT AND CORD CONNECTORS NONMETALLIC - STRAIN RELIEF CORD CONNECTORS

Applications

- For use in wet or dry locations to provide a liquidtight and strain relief termination for flexible cord and cable
- Nonmetallic liquidtight strain relief cord connectors are suitable for use in Class 1, Division 2; Class 2, Divisions 1 and 2; and Class 3, Divisions 1 and 2 hazardous locations

Product Features

- Nylon construction is lightweight and easy to use
- Neoprene grommet
- Resists most common industrial corrosives
- Color-coded Gotcha® ring provides fast identification of cord size

DIAMETER RANGE	COLOR CODE
.062-.125	Green
.125-.187	Orange
.187-.250	Red
.250-.312	Black
.312-.375	White
.250-.375	White
.375-.437	Blue
.375-.500	Blue
.500-.625	Brown
.625-.750	Yellow
.750-.875	Purple
.875-1.000	Grey
1.000-1.125	Pink

Compliances

-  - Standard 514B
-  - C22.2 #18

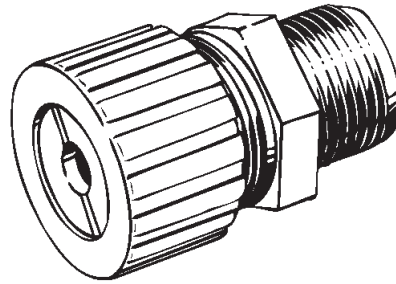

STRAIGHT CONNECTORS
NYLON

ORDERING INFORMATION - DIMENSIONS

STRAIGHT CONNECTORS - NYLON			
CATALOG NUMBER	CABLE RANGE	SHIP CTN. QTY.	UPC. BAR CODE
1/4" HUBS - FORM 1			
4699-5	.312 -.375	25	—
3/8" HUBS - FORM 1			
4700-3	.187 -.250	25	—
4700-4	.250 -.312	25	—
4700-5	.312 -.375	25	—
4700-6	.375 -.437	25	—
1/2" HUBS - FORM 2			
4702-1	.062 -.125	25	—
4702-3	.187 -.250	25	—
4702-4	.250 -.375	25	—
4702-5	.375 -.500	25	—
4702-6	.500 -.625	25	—
3/4" HUBS - FORM 3			
4703-1	.375 -.500	15	—
4703-2	.500 -.625	15	—
4703-3	.625 -.750	15	—
4703-4	.750 -.875	15	—
1" HUBS - FORM 4			
4704-3	.625 -.750	10	—
4704-5	.875 -1.000	10	—
4704-6	1.000 -1.125	10	—

DIMENSIONS					
HUB SIZE	FORM SIZE	A	B	C	D
1/4"	F1	63/64"	7/16"	1-3/32"	21/64"
3/8"	F1	63/64"	7/16"	1-3/32"	7/16"
1/2"	F2	1-1/4"	17/32"	1-1/2"	37/64"
3/4"	F3	1-31/64"	35/64"	1-5/8"	49/64"
1"	F4	1-27/32"	11/16"	1-3/4"	1-1/64"

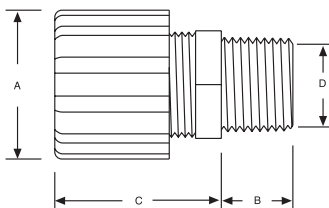

A = Nut O.D.
B = Thread length
C = Length to shoulder
D = Throat I.D.

LIQUIDTIGHT CONDUIT AND CORD CONNECTORS NONMETALLIC - 90 DEGREE STRAIN RELIEF CORD CONNECTORS

Applications

- For use in wet or dry locations to provide a liquidtight and strain relief termination for flexible cord and cable
- Nonmetallic liquidtight strain relief cord connectors are suitable for use in Class 1, Division 2; Class 2, Divisions 1 and 2; and Class 3, Divisions 1 and 2 hazardous locations

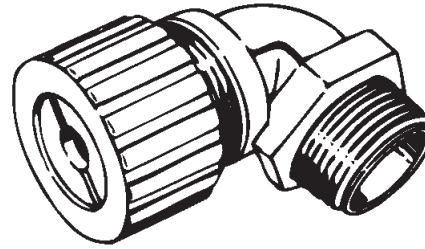

90 DEGREE CONNECTORS
NYLON

Product Features

- Nylon construction is lightweight and easy to use
- Neoprene grommet
- Resists most common industrial corrosives
- Color-coded Gotcha® ring provides fast identification of cord size

DIAMETER RANGE	COLOR CODE
.187-.250	Red
.250-.375	White
.375-.500	Blue
.500-.625	Brown
.625-.750	Yellow
.750-.875	Purple
.875-1.000	Grey

Compliances

- - Standard 514B
- - C22.2 #18

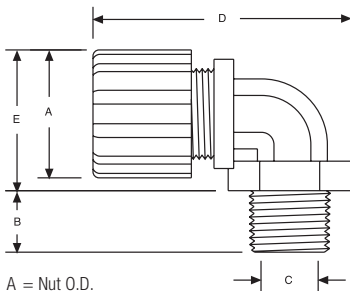

A = Nut O.D.
B = Thread length
C = Throat I.D.
D = Overall length
E = Height from shoulder to nut

ORDERING INFORMATION - DIMENSIONS

90 DEGREE CONNECTORS - NYLON			
CATALOG NUMBER	CABLE RANGE	SHIP CTN. QTY.	UPC BAR CODE
1/2" HUBS - FORM 2			
4792-4	.250 -.375	25	—
4792-5	.375 -.500	25	—
4792-6	.500 -.625	25	—
3/4" HUBS - FORM 3			
4793-1	.375 -.500	15	—
1" HUBS - FORM 4			
4794-3	.625 -.750	10	—
4794-4	.750 -.875	10	—
4794-5	.875 -1.000	10	—

DIMENSIONS						
HUB SIZE	FORM SIZE	A	B	C	D	E
1/2"	F2	1-1/4"	17/32"	37/64"	2-1/2"	1-13/32"
3/4"	F3	1-31/64"	35/64"	49/64"	2-51/64"	1-21/32"
1"	F4	1-27/32"	11/16"	1-1/64"	3-19/64"	1-63/64"

LIQUIDTIGHT CONDUIT AND CORD CONNECTORS ALUMINUM - STRAIGHT STRAIN RELIEF CORD CONNECTORS

Applications

- For use in wet or dry locations to provide a liquidtight and strain relief termination for flexible cord and cable
- Aluminum liquidtight strain relief cord connectors are suitable for use in Class 1, Division 2; Class 2, Divisions 1 and 2; and Class 3, Divisions 1 and 2 hazardous locations

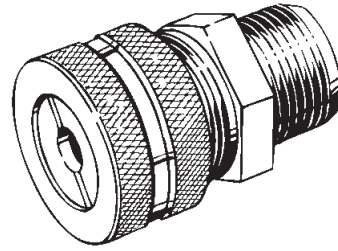

STRAIGHT CONNECTORS
ALUMINUM

Product Features

- Aluminum construction provides a corrosion-resistant installation
- Patented Gotcha® ring incorporates a split hinge design to prevent friction and to provide strain relief
- Neoprene grommet
- Knurled compression nut allows the fittings to be hand tightened to UL requirements
- Gotcha® ring is color-coded for sizing identification

DIAMETER RANGE	COLOR CODE
.062-.125	Green
.125-.187	Orange
.187-.250	Red
.250-.312	Black
.312-.375	White
.250-.375	White
.375-.437	Blue
.375-.500	Blue
.500-.625	Brown
.625-.750	Yellow
.750-.875	Purple
.875-1.000	Grey
1.000-1.125	Pink

Compliances

- - Standard 514B
- - C22.2 #18

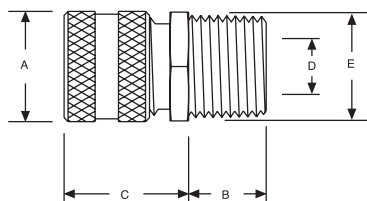

A = Nut O.D.
B = Thread length
C = Length to shoulder
D = Throat I.D.
E = Hex

ORDERING INFORMATION - DIMENSIONS

STRAIGHT CONNECTORS - ALUMINUM			
CATALOG NUMBER	CABLE RANGE	SHIP CTN. QTY.	UPC BAR CODE
1/2" HUBS - FORM 1			
4801-2	.187-.250	25	—
4801-3	.250-.312	25	—
4801-4	.312-.375	25	—
4801-5	.375-.437	25	—
1/2" HUBS - FORM 2			
4801-0	.062-.125	25	—
4801-1	.125-.187	25	—
4802-4	.375-.500	25	—
4802-5	.500-.625	25	—
1/2" HUBS - FORM 3			
4802-8	.625-.750	15	—
4802-9	.750-.875	15	—
3/4" HUBS - FORM 2			
4803-2	.187-.250	25	—
4803-3	.250-.375	25	—
4803-4	.375-.500	25	—
4803-5	.500-.625	25	—
3/4" HUBS - FORM 3			
4803-8	.625-.750	15	—
4803-9	.750-.875	15	—
1" HUBS - FORM 4			
4804-0	.375-.500	10	—
4804-1	.500-.625	10	—
4804-2	.625-.750	10	—
4804-3	.750-.875	10	—
4804-4	.875-1.000	10	—
4804-5	1.000-1.125	10	—

DIMENSIONS							
HUB SIZE	FORM SIZE	A DIA.	B REF.	C	D	E	
						A/C*	A/F**
1/2"	F1	.88"	.46"	.90"	.44"	1.00"	.88"
1/2"	F2	1.13"	.55"	1.10"	.64"	1.11"	1.00"
1/2"	F3	1.38"	.55"	1.50"	.64"	1.40"	1.25"
3/4"	F2	1.13"	.55"	1.10"	.64"	1.29"	1.13"
3/4"	F3	1.38"	.55"	1.50"	.82"	1.40"	1.25"
1"	F4	1.75"	.71"	1.60"	1.02"	1.81"	1.62"

* A/C=Across corners
**A/F=Across flats