

# Snaptec Standard

Snaptec represents a new generation of strain relief fittings for fast installation, featuring excellent pull-out resistance. Assembly is possible from the outside of the enclosure, requiring no tools or locknut. The unique concept saves time and money.

Typical applications:

- Machine, apparatus and plant equipment
- Measuring, control and feedback systems
- Control cabinets
- Railroad cars and vehicles
- Industrial applications

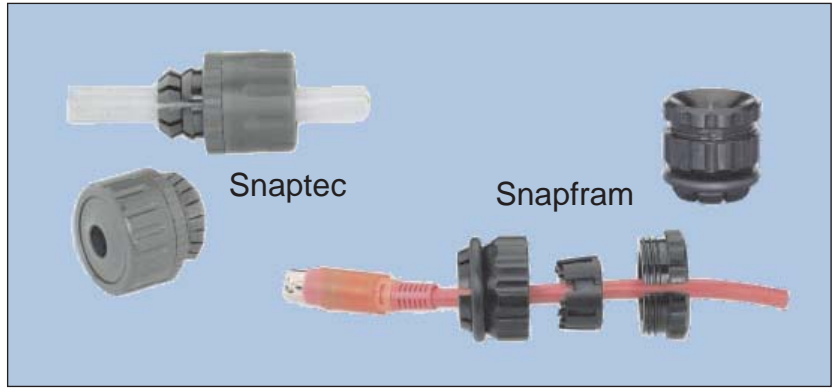

**Snaptec**

Snap-in strain relief fittings without thread for a panel thickness range of 1 – 3 mm (.04" to .12")

**Snapfram**

Split snap-in strain relief fittings without thread for moulded cable assemblies for a panel thickness range of 1 – 3 mm (.04" to .12")

## Assembly Instructions

### Snaptec Patented Strain Relief Fittings – The Next Generation

**Assembly without tools. No locknut is needed!**

1. Push Snaptec into mounting hole
2. Insert cable and pull back slightly
3. Hold Snaptec against the housing and tighten the nut – finished!



**Push into hole**  
✓

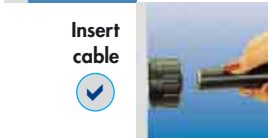

**Insert cable**  
✓



**Tighten nut**  
✓



**Finished**  
✓ **Snaptec®**  
The strain relief fitting without thread

## Assembly Instructions

### Snapfram

**The slit fitting for moulded cable assemblies**

1. Slide bushing (5) and O-ring (6) over cable assembly with moulded plug.
2. Pry the slit adapter (4) and slit clamping ring (3) open and slide over cable.
3. Peel off the multiperforated rings of the slit seal ring (2) until it matches the cable diameter. Slide over cable.
4. Fold the individual parts together and slide inside bushing (5).
5. Slide the slit jam nut (1) around the cable and finger tighten into bushing (5).
6. Push Snapfram into the panel hole and tighten the jam nut.

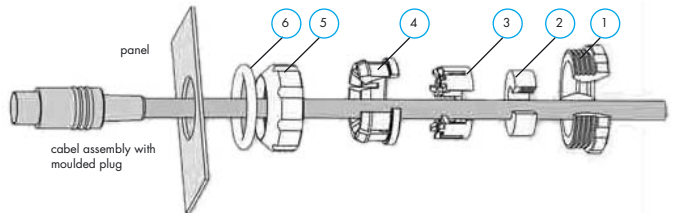

## Snaptec

Snap-in strain relief fittings without thread for a panel thickness range of 1 – 3 mm (.04" to .12")

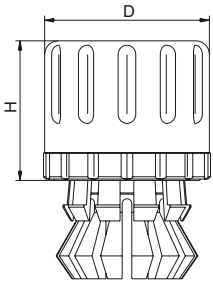

Material: PA (Nylon)  
 Protection: IP 54 (NEMA 2)  
 Seal: Buna-N  
 Operating Temperature: -20°C – 80°C (-4°F – 176°F)  
 Panel thickness range: 1 – 3 mm (.04" to .12")



For Holes mm	Øk mm	D mm	H mm	Number
12	3 - 5	22	26	1.550.1201.50
16	5 - 10	25	27	1.550.1601.50
20	7 - 12	30	29	1.550.2001.50

To learn more about B-I-A please visit us at our  
 WEB site: [www.BiaGmbH.com](http://www.BiaGmbH.com)



