

SINGLE-GANG EXTENSIONS AND ADAPTERS DIE CAST ALUMINUM



Applications

- Used to provide additional capacity needed for NEC box fill requirements
- Adapters allow installer to add "take-offs" to new boxes/devices

Product Features

- Installation hardware, gasket, and ground screw provided
- Closure plugs provided for two- and six-outlet styles

Compliances

-  – Standard 514A
-  – C22.2 No. 18
- NEMA 3R Rated

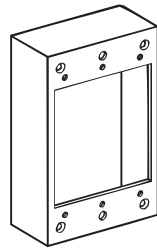

5406-0

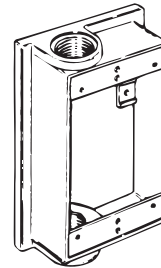

5399-0, 5403-0

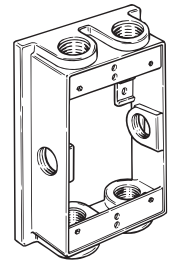

5400-0 TO 5400-5
5405-0

EXTENSIONS CAT. NO. 5406-0

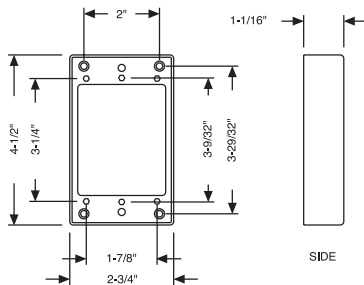

CAT. NOS. 5399-0, 5403-0

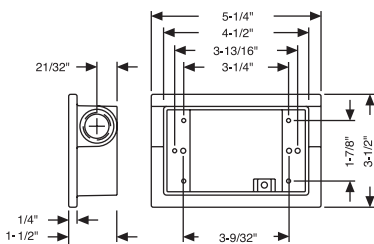

ORDERING INFORMATION - DIMENSIONS

SINGLE-GANG EXTENSION - 4-1/2" x 2-3/4" x 1" DEEP						
CATALOG NUMBER	CUBIC IN.	DESCRIPTION		PKG. TYPE	STD. PKG.	UPC BAR CODE
		COLOR	OUTLETS			
5406-0	10.1	Gray	—	Shrink	25	

No ground screw provided

SINGLE-GANG - EXTENSION ADAPTERS - 5-1/4" x 3-1/2" x 1-1/2" DEEP - TWO THREADED OUTLETS						
CATALOG NUMBER	CUBIC IN.	DESCRIPTION		PKG. TYPE	STD. PKG.	UPC BAR CODE
		COLOR	OUTLETS			
5399-0	13.3	Gray	2-1/2"	Shrink	20	
5403-0	13.3	Gray	2-3/4"	Shrink	20	

Includes one closure plug

SINGLE-GANG - EXTENSION ADAPTERS - 5-1/4" x 3-1/2" x 1-1/2" DEEP - SIX THREADED OUTLETS						
CATALOG NUMBER	CUBIC IN.	DESCRIPTION		PKG. TYPE	STD. PKG.	UPC BAR CODE
		COLOR	OUTLETS			
5400-0	13.3	Gray	6-1/2"	Shrink	20	
5400-5*	13.3	Gray	6-1/2"	Carded	6	
5405-0	13.3	Gray	6-3/4"	Shrink	20	

Includes three closure plugs

*Includes five closure plugs

5400-0 SERIES

